

VILLAGE OF LOMBARD  
 DUPAGE COUNTY  
 CONTRACT NO.

**PERMIT PLANS**  
**FEB. 20, 2012**

**INDEX OF SHEETS**

- 1 COVER SHEET
- 2 GENERAL NOTES AND SUMMARY OF QUANTITIES
- 3 OVERALL PLAN
- 4 TYPICAL SECTIONS
- 5-6 PROPOSED GRADING & UTILITY PLAN
- 7 EROSION CONTROL NOTES
- 8 EROSION CONTROL DETAILS
- 9-10 WETLAND, BUFFER & RIPARIAN PLAN
- 11 STORM WATER PUMP STATION PROPOSED SITE PLAN
- 12-15 STORM WATER PUMP STATION PROPOSED SITE DETAILS
- 16 CONSTRUCTION DETAILS

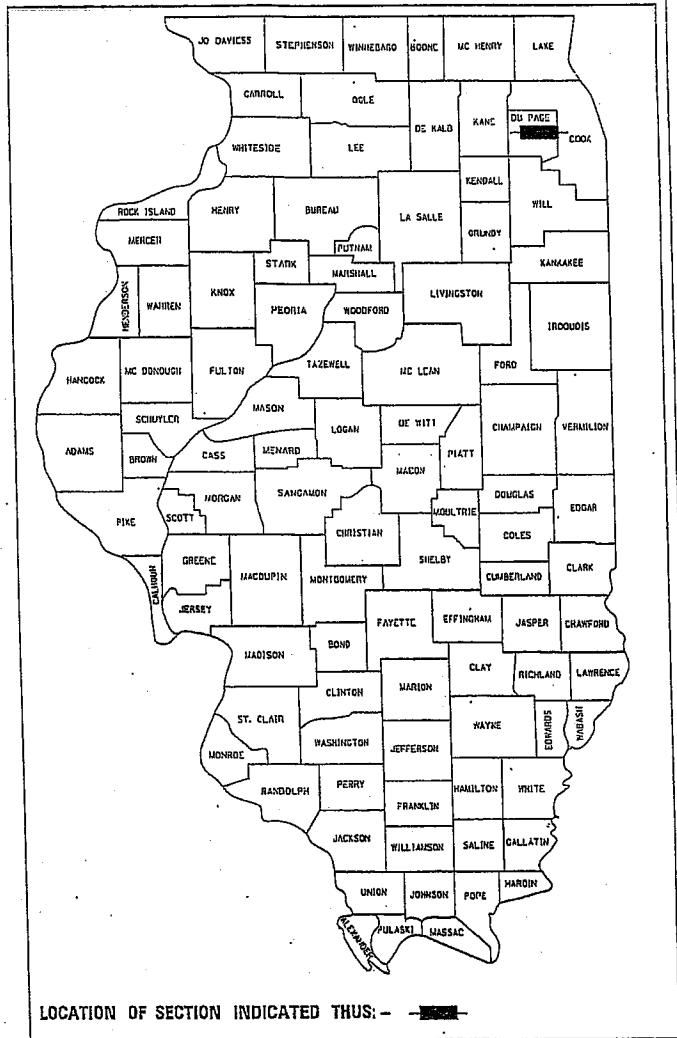
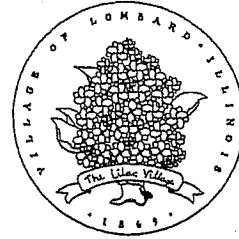

THE CONTRACTOR SHALL BE SOLELY RESPONSIBLE FOR JOB SITE SAFETY AS WELL AS SUPERVISION/DIRECTION AND MEANS/METHODS OF CONSTRUCTION.

CALL JULIE @ 8-1-1 OR 1-800-892-0123

WITH THE FOLLOWING:  
 COUNTY —DUPAGE  
 CITY-TOWNSHIP LOMBARD - ADDISON  
 SEC. & 1/4 SEC.NO. # T40N R11E SEC. 32

**48 HOURS BEFORE YOU DIG.**  
 EXCLUDING SAT., SUN., & HOLIDAYS



PROJECT LOCATION

N. T. S.

PROJECT LOCATION

CRYSTAL AVE AND GREENFIELD AVE  
 30 MPH POSTED SPEED LIMIT

ENGINEER DATE  
 BRYAN L. LUKE  
 ILLINOIS REGISTRATION No. 062-051360  
 AS AN OFFICIAL ACT AS DESIGN ENGINEER, I HEARBY SEAL THESE PLANS.  
 MY REGISTRATION EXPIRES 11/30/2013.

VILLAGE OF LOMBARD

APPROVED \_\_\_\_\_ 20\_\_\_\_  
 PRESIDENT OF BOARD OF TRUSTEES

PLANS PREPARED BY:  
**CHRISTOPHER B. BURKE ENGINEERING, LTD.**  
 9575 W. Higgins Road, Suite 600  
 Rosemont, Illinois 60018  
 (847) 823-0500

PROFESSIONAL DESIGN FIRM NO.: 184-001175  
 EXPIRATION DATE: APRIL 30, 2013

7/21/2012 N:\M\_lombard\110256\DWG\110256.SHT

NO.	DATE	REVISION	BY

SCALE: NO SCALE	DATE: 2/21/2012
DRAWN BY:	DATE:
CHECKED BY:	DATE:
APPROVED BY:	DATE:



Village of Lombard  
 255 EAST WILSON AVENUE  
 LOMBARD, IL 60148-3931  
 (630) 620-5700

PROJECT: TERRACE VIEW POND IMPROVEMENTS

TITLE: COVER SHEET

PROJ. NO: 110256  
 SHEET 1 OF 16  
 FILE:

**SPECIFICATIONS, STANDARDS, AND SPECIAL PROVISIONS**

- ALL REFERENCES TO STANDARD SPECIFICATIONS IN THESE GENERAL NOTES SHALL BE INTERPRETED TO MEAN THE "STANDARD SPECIFICATIONS FOR ROAD AND BRIDGE CONSTRUCTION" ADOPTED BY THE ILLINOIS DEPARTMENT OF TRANSPORTATION, JANUARY 1, 2012 AND THE "SUPPLEMENTAL SPECIFICATIONS AND RECURRING SPECIAL PROVISIONS", ADOPTED JANUARY 1, 2012.
- ALL CONSTRUCTION SHALL BE IN ACCORDANCE WITH THE STANDARD SPECIFICATIONS; THE LATEST EDITION OF THE "ILLINOIS MANUAL ON UNIFORM TRAFFIC CONTROL DEVICES FOR STREETS AND HIGHWAYS", (IMUTCD); THE "STANDARD SPECIFICATIONS FOR TRAFFIC CONTROL ITEMS", (SSCI); "THE STANDARD SPECIFICATIONS FOR WATER AND SEWER MAIN CONSTRUCTION IN ILLINOIS" JULY 2009 6<sup>TH</sup> EDITION, THE "DETAILS" IN THE PLANS AND THE "SPECIAL PROVISIONS, IDOT STANDARD DRAWINGS, AND VILLAGE OF LOMBARD STANDARD DRAWINGS" INCLUDED IN THE CONTRACT DOCUMENTS.
- IN THE GENERAL NOTES, ALL REFERENCES TO ENGINEER SHALL BE INTERPRETED AS THE RESIDENT ENGINEER.

**STAKING**

- THE CONTRACTOR SHALL PROTECT AND CAREFULLY PRESERVE ALL SECTION OR SUBSECTION MONUMENTS OR PROPERTY OR REFERENCE MARKERS UNTIL THE VILLAGE, ITS AGENT OR AN AUTHORIZED SURVEYOR HAS WITNESSED OR OTHERWISE REFERENCED THEIR LOCATIONS.
- ALL RADII FOR PROPOSED CURB AND GUTTER ARE TO THE EDGE OF PAVEMENT UNLESS OTHERWISE NOTED.
- THE STATION/OFFSET/ELEVATIONS NOTED FOR ALL DRAINAGE STRUCTURES LOCATED IN THE CURB LINE REFER TO THE POSITION OF THE ADJACENT PROPOSED EDGE OF PAVEMENT. THE CONTRACTOR SHALL BE RESPONSIBLE FOR DETERMINING THE OFFSET NECESSARY FOR EACH STRUCTURE TO SET THE FRAME AND GRATE IN THE PROPER LOCATION. ALL OTHER STRUCTURES ARE DIMENSIONED TO THE CENTER OF STRUCTURE.
- PAVEMENT GRADES: THE ELEVATIONS INDICATED ON THE PLANS ARE FINISHED GRADES OF PROPOSED PAVEMENT, UNLESS OTHERWISE INDICATED.

**TREE REMOVAL, CLEARING AND HEDGE REMOVAL**

- ALL TREES ARE DESIGNATED TO BE SAVED UNLESS OTHERWISE NOTED ON THE PLANS, AND SHALL BE PROTECTED IN ACCORDANCE WITH THE PROVISIONS OF ARTICLE 201.05 OF THE STANDARD SPECIFICATIONS.
- ALL CLEARING AND REMOVAL OF BUSHES, HEDGES AND TREES UNDER 6" IN DIAMETER SHALL BE INCIDENTAL TO THE COST OF EARTH EXCAVATION.

**UTILITIES**

- PRIOR TO THE START OF THE CONSTRUCTION OPERATIONS, THE CONTRACTOR SHALL COORDINATE CONSTRUCTION ACTIVITIES WITH UTILITY COMPANIES. THE LOCATION OF PUBLIC OR PRIVATE UTILITIES SHOWN ON THE PLANS ARE APPROXIMATE AND THE VILLAGE OF LOMBARD DOES NOT GUARANTEE THEIR ACCURACY. THE CONTRACTOR WILL BE REQUIRED TO ASCERTAIN THE EXACT LOCATION OF SUCH UTILITIES AND EXERCISE CARE DURING CONSTRUCTION OPERATIONS SO AS NOT TO DAMAGE THEM IN ACCORDANCE WITH THE SPECIAL PROVISIONS AND ARTICLE 107.31 OF THE STANDARD SPECIFICATIONS. THE CONTRACTOR SHALL BE RESPONSIBLE FOR CONTACTING THE OWNERS OF ALL EXISTING UTILITIES SO THAT THEIR FACILITIES MAY BE LOCATED AND ADJUSTED OR MOVED.
- BEFORE STARTING ANY EXCAVATION, THE CONTRACTOR SHALL CALL "JULIE" AT 1-800-892-0123 FOR FIELD LOCATIONS OF BURIED ELECTRIC, TELEPHONE, GAS, WATER, SEWER, AND CABLE TELEVISION FACILITIES. (48 HOURS NOTIFICATION IS REQUIRED.)
- THE VILLAGE OF LOMBARD WILL LOCATE EXISTING SANITARY AND WATER SERVICES TO THE INDIVIDUAL RESIDENCES WITHIN THE PROJECTS LIMITS. THESE SERVICES WILL BE LOCATED ONE TIME ONLY. FROM THEN ON THE CONTRACTOR SHALL DOCUMENT AND BE RESPONSIBLE FOR MAINTAINING KNOWLEDGE OF THE LOCATIONS OF THESE SERVICES. THE CONTRACTOR IS RESPONSIBLE FOR MAINTAINING AS-BUILT KNOWLEDGE OF THE LOCATION (INCLUDING ELEVATIONS) OF THE NEWLY INSTALLED SERVICES AND MAINS. THE VILLAGE WILL NOT BE RESPONSIBLE FOR LOCATING NEW MAINS OR SERVICES FOR THE CONTRACTOR. THIS IS IN EFFECT UNTIL FINAL PAYMENT FROM THE VILLAGE. FOR THE DURATION OF THE CONTRACT, THE CONTRACTOR SHALL MAKE THE AS-BUILT UNDERGROUND UTILITY INFORMATION AVAILABLE TO THE VILLAGE WHENEVER REQUESTED. IN THE EVENT OF A "JULIE" CALL WITHIN THE PROJECT LIMITS, THE VILLAGE OR ITS AGENT WILL NOTIFY THE CONTRACTOR TO MARK ANY UTILITIES STILL UNDER THE CONTRACTORS RESPONSIBILITY.
- THE CONTRACTOR SHALL BE RESPONSIBLE FOR THE PROTECTION OF ALL ABOVE AND BELOW GROUND UTILITIES EVEN THOUGH THEY MAY NOT BE SHOWN ON THE PLANS. ANY UTILITY THAT IS DAMAGED DURING CONSTRUCTION SHALL BE REPAIRED OR REPLACED TO THE SATISFACTION OF THE ENGINEER OR THE VILLAGE OF LOMBARD. THIS WORK SHALL BE AT THE CONTRACTOR'S EXPENSE.
- THE CONTRACTOR SHALL COOPERATE WITH THE VILLAGE OF LOMBARD IN ANY UNDERGROUND UTILITY CONSTRUCTION WHICH THE VILLAGE MAY WANT TO PLACE DURING THE CONTRACTOR'S OPERATIONS.
- ALL MANHOLES, CATCH BASINS, AND VALVE VAULTS SHALL BE MORTARED WITH HYDRAULIC CEMENT AS SHOWN ON THE DETAILS ON THE INSIDE AND OUTSIDE AT ALL STRUCTURE JOINTS BETWEEN BARREL, CONE, AND FLAT TOP SECTIONS. ADJUSTING RINGS SHALL BE MORTARED ON THE OUTSIDE AROUND JOINTS TO PREVENT INFILTRATION PROVIDING THEY ARE OUTSIDE OF PAVED AREAS. ONLY NON-PREFORMED MASTIC SHALL BE USED BETWEEN THE FRAME, RINGS, AND TOP OF CONE OR FLAT TOP. (PREFORMED MASTIC -- EZ STICK, RUB-R-NECK, ETC IS NOT ALLOWED ABOVE THE CONE OR FLAT TOP)
- GRADATION OF TRENCH BACKFILL MATERIAL SHALL BE CA-6, AND SHALL BE PLACED IN UNIFORM LAYERS NOT EXCEEDING 12 INCHES (LOOSE MEASURE) AND COMPACTED WITH MECHANICAL EQUIPMENT TO 95% OF STANDARD PROCTOR DENSITY. PIPE BEDDING SHALL BE A MINIMUM OF 4 INCHES THICK.
- ALL FRAMES WITH SELF SEALING CLOSED LIDS TO BE FURNISHED AS PART OF THIS CONTRACT FOR CONSTRUCTION, ADJUSTMENT OR RECONSTRUCTION OF ANY MANHOLES, CATCH BASIN, INLET, VALVE VAULT, OR METER VAULT SHALL HAVE CAST INTO THE LID ONE OF THE FOLLOWING WORDS: ALL LIDS TO BE USED ON STORM SEWER STRUCTURES SHALL BEAR THE WORD "STORM". ALL LIDS TO BE USED ON SANITARY SEWER STRUCTURES SHALL BEAR THE WORD "SANITARY". ALL LIDS TO BE USED ON WATER SYSTEM STRUCTURES SHALL BEAR THE WORD "WATER". ALL CURB BOXES SHALL SAY "DUMP NO WASTE!" OR "DRAINS TO RIVERS" OR SIMILAR. THIS WORK SHALL BE CONSIDERED INCIDENTAL TO THE FRAME AND GRATE OR FRAME AND CLOSED LID PROVIDED.
- WHENEVER DURING CONSTRUCTION OPERATIONS ANY LOOSE MATERIAL IS DEPOSITED IN THE FLOW LINE OF DRAINAGE STRUCTURES SUCH THAT THE NATURAL FLOW OF WATER IS OBSTRUCTED, IT SHALL BE REMOVED AT THE CLOSE OF EACH WORKING DAY. AT THE CONCLUSION OF CONSTRUCTION OPERATIONS, ALL UTILITY STRUCTURES SHALL BE FREE FROM DIRT AND DEBRIS. THE WORK SPECIFIED ABOVE WILL NOT BE PAID FOR SEPARATELY BUT SHALL BE INCLUDED IN THE CONTRACT.
- ALL AUXILIARY VALVES, FRAMES, GRATES, LIDS AND WATER SERVICE BOXES WHICH ARE TO BE ABANDONED OR ADJUSTED WITH A NEW OR DIFFERENT FRAME AND LID SHALL BECOME THE PROPERTY OF THE CONTRACTOR. ALL HYDRANTS TO BE REMOVED SHALL BE REMOVED IN ACCORDANCE WITH THE CONTRACT DOCUMENTS; THE CONTRACTOR SHALL CONTACT THE VILLAGE OF LOMBARD TO DETERMINE IF THE VILLAGE WISHES TO SALVAGE THE HYDRANTS, FRAMES, OR LIDS. THE CONTRACTOR WILL BE RESPONSIBLE TO EITHER RETURN THE HYDRANTS, FRAMES, OR LIDS TO PUBLIC WORKS OR DISPOSE OF THEM.
- AN ESTIMATED QUANTY (3 SQUARES) OF SIDEWALK REMOVAL AND REPLACEMENT HAS BEEN INCLUDED FOR THE INSTALLATION OF THE WATER AND SEWER SERVICES AT EACH PROPERTY WHERE THE EXISTING SIDEWALK IS NOT CALLED OUT TO BE REPLACED. ANY SIDEWALK REMOVAL AND REPLACEMENT AT THESE LOCATIONS SHALL BE APPROVED BY THE ENGINEER.

- ANY EXISTING OR PROPOSED SEWER DAMAGED BY THE CONSTRUCTOR DURING CONSTRUCTION SHALL BE REPLACED BY THE CONTRACTOR TO THE SATISFACTION OF THE ENGINEER AT NO COST TO THE VILLAGE OF LOMBARD.
- THE CONTRACTOR SHALL RECEIVE NO ADDITIONAL COMPENSATION FOR CONSTRUCTION STAGING NECESSARY TO ACCOMMODATE UTILITY RELOCATION OR ADJUSTMENT AND/OR FOR DELAYS CAUSED BY UTILITY RELOCATION OR ADJUSTMENT.
- THE CONTRACTOR SHALL FURNISH ALL LABOR, EQUIPMENT AND MATERIAL NECESSARY FOR DEWATERING TRENCH EXCAVATIONS AS WELL AS SHORING TRENCH WALLS DURING UTILITY OPERATIONS. COMPLIANCE WITH THE ABOVE WILL BE INCIDENTAL TO THE UTILITY INSTALLATIONS.
- ALL PROPOSED UTILITY STRUCTURES SHALL INCLUDE AN EXTERNAL CHIMNEY SEAL UNLESS THEY FALL IN THE PAVEMENT AND ARE ADJUSTED TO FINAL GRADE WITH CLASS SI CONCRETE OR BITUMINOUS SURFACE OR BINDER FULLY COVERING THE RINGS AND CASTING. THE COST OF THE CHIMNEY SEAL SHALL BE CONSIDERED INCIDENTAL TO THE UTILITY STRUCTURE BEING INSTALLED.
- ALL MANHOLES, CATCH BASINS, INLETS, AND VALVE VAULTS CALLED FOR TO BE ADJUSTED OR RECONSTRUCTED IN THE PLANS SHALL BE PAID FOR EACH AS "DRAINAGE AND UTILITY STRUCTURE TO BE ADJUSTED" OR "DRAINAGE AND UTILITY STRUCTURE TO BE RECONSTRUCTED."

**PAVING AND CURB & GUTTER**

- THE CONTRACTOR SHALL SAW CUT PAVEMENT, CURB & GUTTER, AND SIDEWALK AS INDICATED ON THE PLANS TO SEPARATE THE EXISTING MATERIAL TO BE REMOVED BY MEANS OF AN APPROVED CONCRETE SAW TO A DEPTH AS SHOWN ON THE PLANS OR AS DIRECTED BY THE ENGINEER. THIS WORK SHALL BE CONSIDERED INCIDENTAL TO THE ITEM BEING REMOVED.
- THE LIMITS OF UNSUITABLE SOIL REMOVAL HAVE BEEN ESTIMATED USING DATA PROVIDED IN THE ROADWAY SOILS INVESTIGATION DATED XXX XXX, 20XX BY XXXXX. THE LIMITS OF UNDERCUT WILL BE VERIFIED OR RE-ESTABLISHED DURING CONSTRUCTION BY THE ENGINEER BASED ON ACTUAL CONDITIONS. THE PLAN QUANTITIES ARE ESTIMATED AND ANY ADDITIONS OR SUBTRACTIONS RESULTING FROM THE CHANGE IN LIMITS OF UNDERCUTTING SHALL BE MADE BY THE ENGINEER. THE CONTRACTOR WILL BE PAID FOR THE ACTUAL QUANTITY OF WORK PERFORMED.
- BASE COURSE SHALL NOT BE PLACED ADJACENT TO CURB AND GUTTER UNTIL THE CURB AND GUTTER HAS BEEN PROPERLY CURED AND BACKFILLED TO THE SATISFACTION OF THE ENGINEER.
- BITUMINOUS CONCRETE SURFACE COURSE SHALL NOT BE PLACED UNTIL ALL EARTH EXCAVATION, TOP SOIL, SOD PLACEMENT, AND BITUMINOUS CONCRETE BINDER COURSE HAVE BEEN COMPLETED TO THE SATISFACTION OF THE ENGINEER.

**STORM & SANITARY SEWER**

- THE COST OF MAKING SEWER CONNECTIONS TO EXISTING OR PROPOSED SEWER OR DRAINAGE STRUCTURES SHALL BE INCIDENTAL TO THE COST OF THE SEWER OR STRUCTURE BEING CONSTRUCTED.
- WHEN EXISTING DRAINAGE FACILITIES ARE DISTURBED, THE CONTRACTOR SHALL PROVIDE AND MAINTAIN TEMPORARY OUTLETS AND CONNECTIONS FOR ALL PRIVATE OR PUBLIC DRAINS, SEWERS OR CATCH BASINS. THE CONTRACTOR SHALL PROVIDE FACILITIES TO TAKE IN ALL STORM WATER WHICH WILL BE RECEIVED BY THESE DRAINS AND SEWERS AND DISCHARGE THE SAME. HE SHALL PROVIDE AND MAINTAIN AN EFFICIENT PUMPING PLANT, IF NECESSARY, AND A TEMPORARY OUTLET. HE SHALL BE PREPARED AT ALL TIMES TO DISPOSE OF THE WATER RECEIVED FROM TEMPORARY CONNECTIONS UNTIL SUCH TIME AS THE PERMANENT CONNECTIONS WITH SEWERS ARE BUILT AND IN SERVICE. THIS WORK WILL NOT BE PAID FOR SEPARATELY, BUT SHALL BE INCLUDED IN THE CONTRACT.
- ALL ABANDONED PIPE AND STRUCTURE INVERTS SHALL BE PLUGGED WITH BRICK AND MORTAR TO THE SATISFACTION OF THE ENGINEER. THIS WORK SHALL BE INCIDENTAL TO THE STORM OR SANITARY SEWER ITEMS BEING REMOVED.
- THE CONTRACTOR SHALL DETERMINE WHEN FLAT SLAB TOPS ARE REQUIRED ON MANHOLES. NO ADDITIONAL COMPENSATION SHALL BE ALLOWED FOR THE USE OF FLAT SLAB TOPS.
- THE REMOVAL OF END SECTIONS SHALL BE PAID FOR AS "STORM SEWER REMOVAL" OF THE DIAMETER INDICATED.

**SIGNING, STRIPING & LANDSCAPING**

- THOSE SIGNS WHICH ARE SO DESIGNATED BY THE ENGINEER SHALL BE REMOVED, STORED AND SUBSEQUENTLY RELOCATED BY THE CONTRACTOR AT NO ADDITIONAL COST TO THE CONTRACT. IN ADDITION, ANY SIGNS WHICH ARE DAMAGED DURING CONSTRUCTION OPERATIONS BEYOND REPAIR SHALL BE REPLACED IN KIND BY THE CONTRACTOR TO THE SATISFACTION OF THE ENGINEER AT NO ADDITIONAL COST TO THE CONTRACT.
- WHEN DIRECTED BY THE ENGINEER, SUPPLEMENTAL WATERING SHALL BE APPLIED TO ALL SODDED AREAS PRIOR TO FINAL ACCEPTANCE AT A RATE SPECIFIED BY THE ENGINEER AND IN ACCORDANCE WITH THE STANDARD SPECIFICATIONS AND SPECIAL PROVISIONS.
- THE CONTRACTOR SHALL ADHERE TO LIMITS OF RESTORATION SHOWN. AREAS OUTSIDE THESE LIMITS THAT ARE DAMAGED OR DISTURBED BY THE CONTRACTOR SHALL BE RESTORED BY THE CONTRACTOR AT HIS EXPENSE, AND NO ADDITIONAL COMPENSATION WILL BE ALLOWED.

**MISCELLANEOUS**

- DIMENSIONS: IT SHALL BE THE CONTRACTOR'S RESPONSIBILITY TO VERIFY ALL DIMENSIONS AND CONDITIONS EXISTING IN THE FIELD PRIOR TO ORDERING MATERIALS AND BEGINNING CONSTRUCTION.
- RESERVED
- ALL WASTE MATERIAL SHALL BE LEGALLY DISPOSED OF OUTSIDE THE LIMITS OF THE RIGHT-OF-WAY AT THE CONTRACTOR'S EXPENSE.
- THE CONTRACTOR SHALL ADHERE TO IDOT STANDARD DRAWING NO. 703.801 WHEN CLOSING ANY SIDEWALK.
- ESTIMATED LOCATIONS OF SIDEWALK REMOVAL AND REPLACEMENT HAVE BEEN SHOWN ON THE PLANS. THE ENGINEER WILL DETERMINE THE EXACT LIMITS IN THE FIELD DURING CONSTRUCTION.
- PAY ITEMS IN THE SUMMARY OF QUANTITIES HAVE BEEN ESTIMATED. IF, IN THE ENGINEER'S OPINION, THE WORK IS NOT REQUIRED, THE ITEM WILL BE DEDUCTED FROM THE CONTRACT AND NO ADDITIONAL COMPENSATION WILL BE ALLOWED.
- BARRICADES: THE CONTRACTOR SHALL PROVIDE AND INSTALL TWO (2) WEIGHTED SAND BAGS ON EACH TYPE I OR II BARRICADE USED. (ONE (1) WEIGHTED BAG ACROSS EACH BOTTOM RAIL.)

VOL ISSUE DATE: 1-25-07



**CHRISTOPHER B. BURKE ENGINEERING, LTD.**  
 9575 W. Higgins Road, Suite 600  
 Rosemont, Illinois 60018  
 (847) 823-0500

CLIENT:



**VILLAGE OF LOMBARD**

NO.	DATE	NATURE OF REVISION	CHKD.	MODEL:
				Default
FILE NAME	H:\Lombard\10256\CivR\NOT_10256.SHT			

TITLE:

**TERRACE VIEW POND IMPROVEMENTS**

**GENERAL NOTES**

PROJ. NO.	110256
DATE:	02/20/12
SHEET 2	OF 16



TERRACE VIEW POND  
 HWL=692.2  
 EX NWL=688.5  
 PR NWL=687.5

PARK VIEW  
 ELEMENTARY SCHOOL

CONTROL POINT  
 LOMBARD 11-002  
 N 490810.10  
 1188577.91

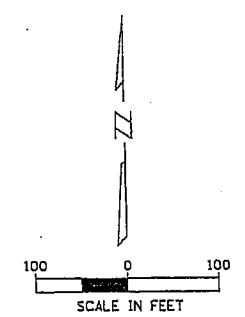

ELEVATION BENCHMARKS DATUM: LOMBARD		
NO.	DESCRIPTION	ELEV.
1-002	INTERSECTION OF STATE HIGHWAY ROUTE 53 AND ROUTE 64 (NORTH AVENUE). GO EAST ON ROUTE 64 TO THE INTERSECTION WITH MAIN STREET. TURN RIGHT AND GO SOUTH TO THE INTERSECTION WITH GREENFIELD AVENUE. THE STATION IS LOCATED 0.25 MILES WEST OF THE INTERSECTION OF MAIN STREET AND GREENFIELD AVENUE. IT IS LOCATED 5.8 FT. NORTH OF THE NORTH SIDE OF GREENFIELD AVENUE AND 7 FT. SOUTH OF THE CONCRETE SIDEWALK. THE MARKER IS A BRONZE DISC SET IN CONCRETE BASE.	
1-007	EAST ON ROUTE 64 APPROXIMATELY 1/4 MILE EAST OF ROUTE 53 TO MAIN STREET. SOUTH ON MAIN ST. TO GREENFIELD AVENUE. WEST ON GREENFIELD AVENUE 0.5 MILES TO WEST ROAD. THE BENCHMARK IS LOCATED AT THE SOUTHWEST CORNER OF THE INTERSECTION OF WEST ROAD AND GREENFIELD AVENUE. THE MARKER IS A VILLAGE OF LOMBARD 3RD ORDER BENCHMARK 2 FT. FROM THE BENCHMARK IS APPROXIMATELY 3 FT. NORTH OF THE NORTH EDGE OF SIDEWALK AND 3 FT. WEST OF THE WEST EDGE OF SIDEWALK.	

LEGEND	
	100 YR FLOODPLAIN (692.2) - FROM DUPAGE COUNTY RFM
	EXISTING WATERS EDGE
	WETLAND
	WETLAND BUFFER (100')

**CB**  
 CHRISTOPHER B. BURKE ENGINEERING, LTD.  
 9575 W. Higgins Road, Suite 600  
 Rosemont, Illinois 60018  
 (847) 823-0500

CLIENT:  
  
**VILLAGE OF LOMBARD**

NO.	DATE	NATURE OF REVISION	CHKD.	MODEL:
				Default
FILE NAME		N:\Lombard\110256\CIVIL\OVERALL_110256.SHT		

TITLE:  
**TERRACE VIEW POND IMPROVEMENTS  
 OVERALL PLAN**

PROJ. NO. 110256  
 DATE: 02/20/12  
 SHEET 3 OF 16

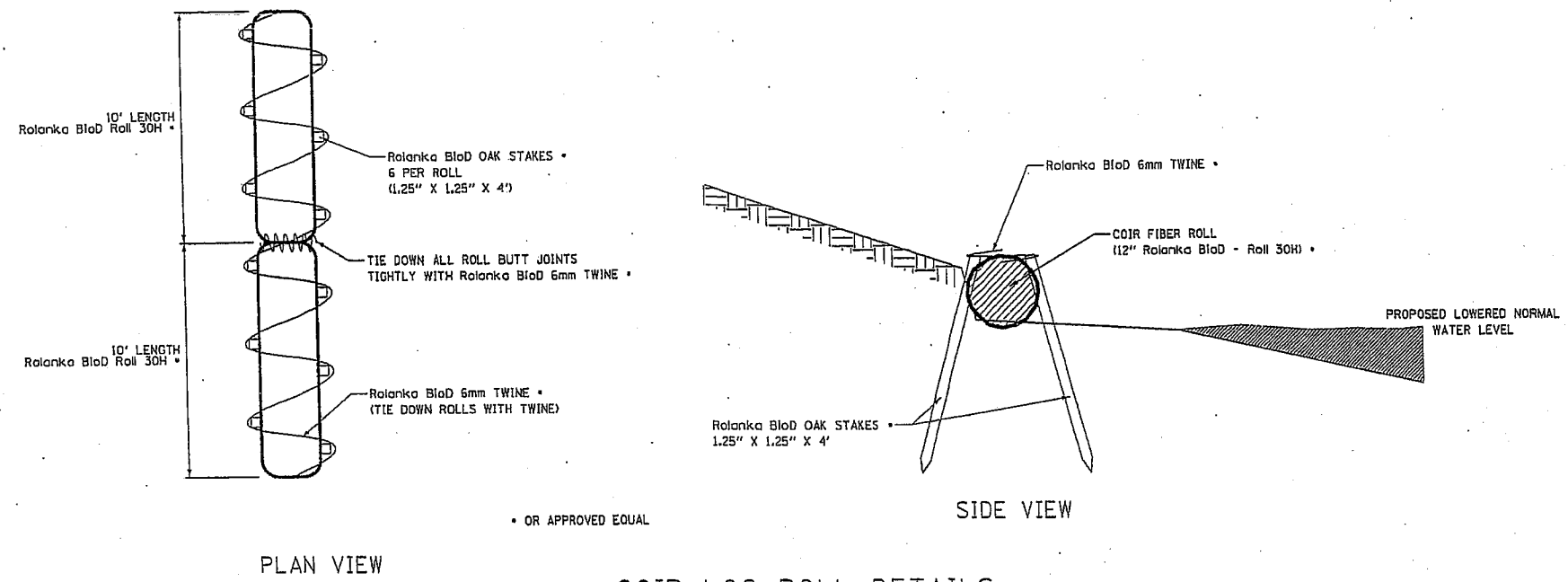

COIR LOG ROLL DETAILS

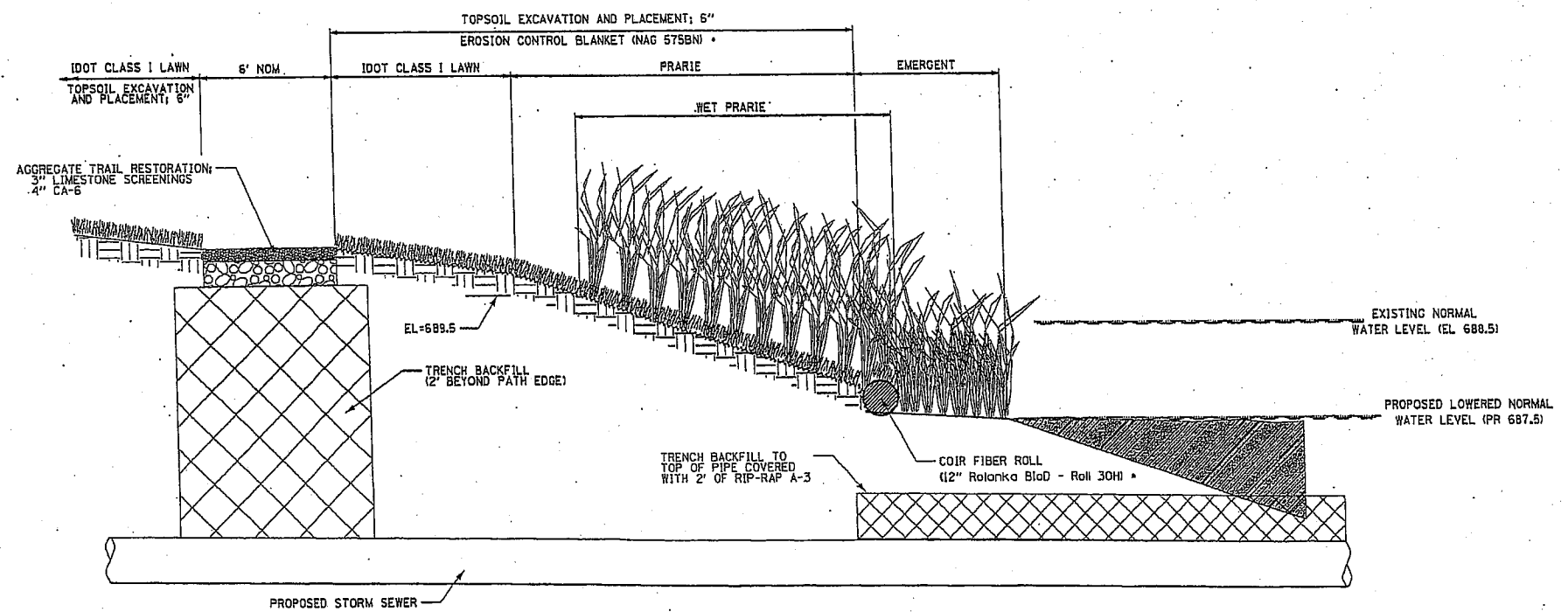

SHORELINE SEEDING AND RESTORATION DETAIL  
(WITH IN GRADED/DISTURBED AREA)

EMERGENT SEEDING - MUDFLAT AND FIBER ROLL  
 WET PRARIE SEEDING - FIBER ROLL TO 689.5  
 PRARIE - TOE OF SLOPE TO MATCH LIMIT OF ADJOINING PRARIE PLANTS  
 IDOT CLASS 1 LAWN MIX - INSTALL BEYOND NATIVE LIMIT

NO.	DATE	NATURE OF REVISION	CHKD.	MODEL:	Default
FILE NAME	H:\Lombard\110256\Civ\TYP\110256-01.SHT				

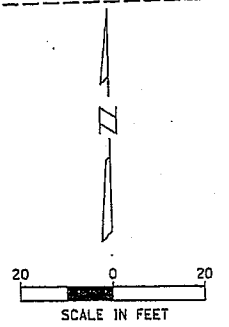
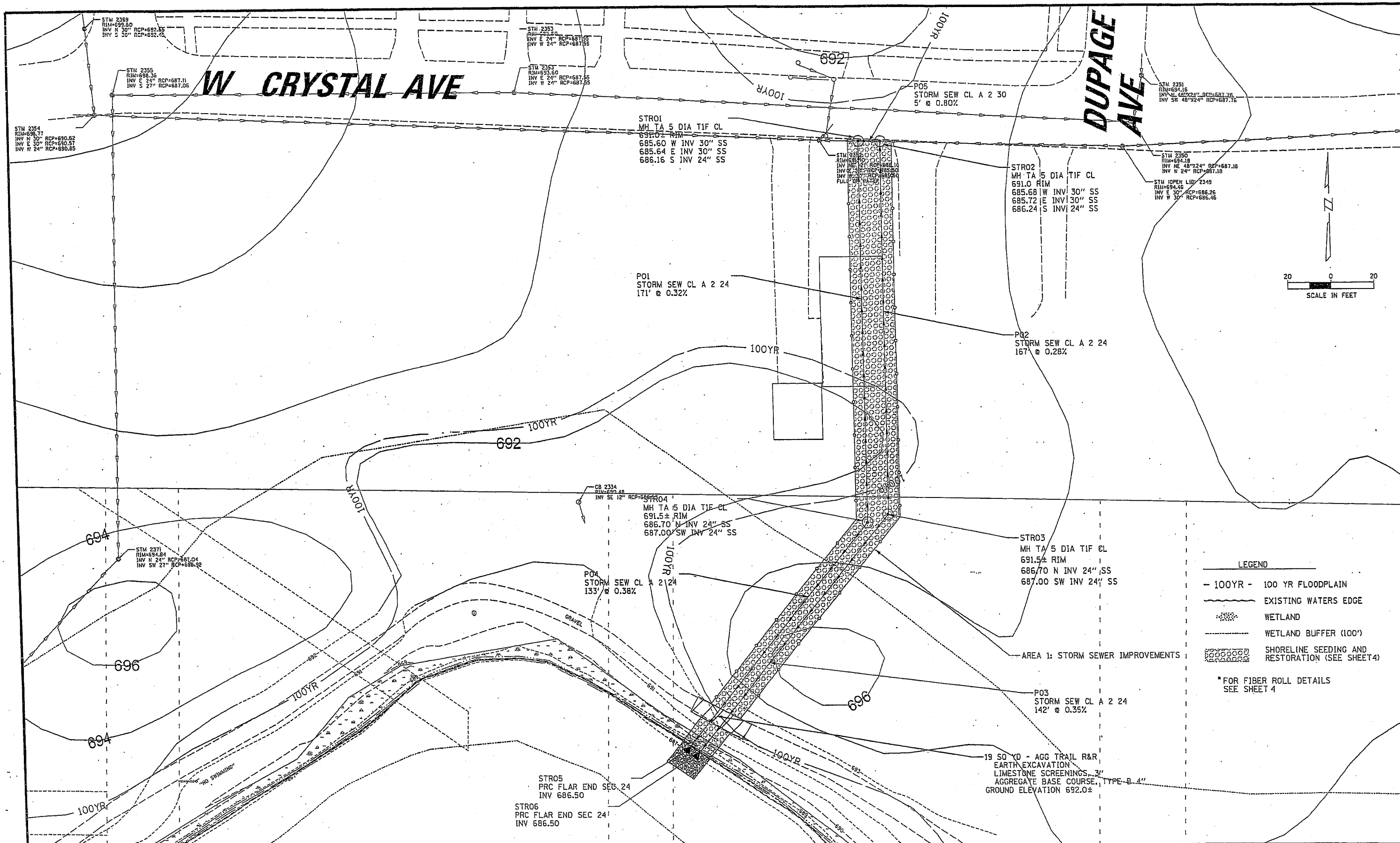

- LEGEND**
- 100YR - 100 YR FLOODPLAIN
  - - - - - EXISTING WATERS EDGE
  - ▨ WETLAND
  - - - - - WETLAND BUFFER (100')
  - ▨ SHORELINE SEEDING AND RESTORATION (SEE SHEET 4)
- \* FOR FIBER ROLL DETAILS SEE SHEET 4

**CHRISTOPHER B. BURKE ENGINEERING, LTD.**  
9575 W. Higgins Road, Suite 600  
Rosemont, Illinois 60018  
(847) 823-0500

CLIENT:  
  
**VILLAGE OF LOMBARD**

NO.	DATE	NATURE OF REVISION	CHKD.	MODEL

FILE NAME: N:\Lombard\110256\Civil\PLN\_110256-01.SHT

DESIGNER:          DGN:  
DRAWN:             DWN:  
CHECKED:          CHKD:  
SCALE:             20'  
PLOT DATE:        2/21/2012  
CAD USER:        mvrorder  
TITLE:             **TERRACE VIEW POND IMPROVEMENTS  
PROPOSED GRADING AND UTILITY PLAN**

PROJ. NO. 110256  
DATE: 02/20/12  
SHEET 5 OF 16

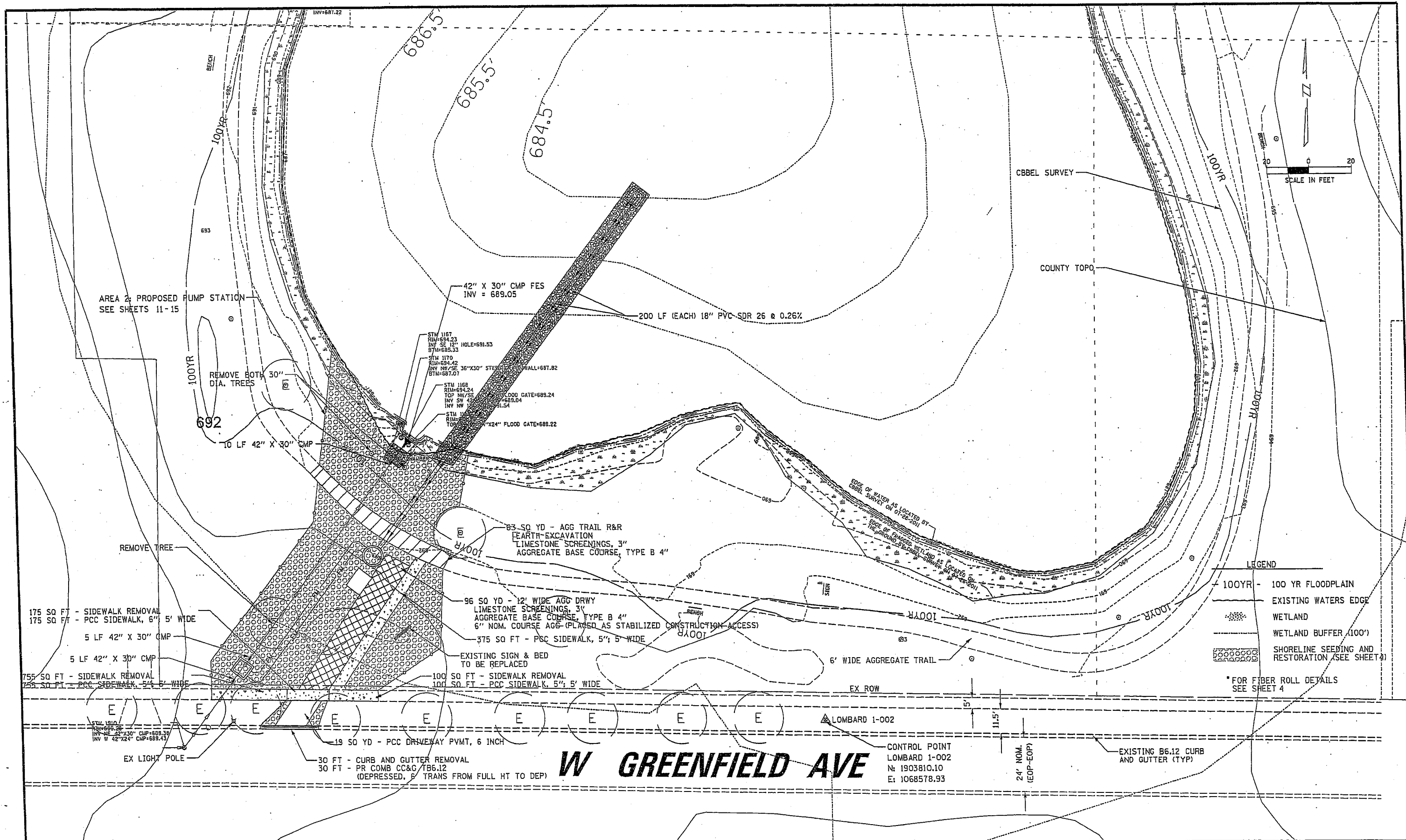

**CHRISTOPHER B. BURKE ENGINEERING, LTD.**  
 9575 W. Higgins Road, Suite 600  
 Rosemont, Illinois 60018  
 (847) 823-0500

CLIENT:  
  
**VILLAGE OF LOMBARD**

NO.	DATE	NATURE OF REVISION	CHKD.	MODEL
FILE NAME	H:\Lombard\110256\Civil\PLAN_110256-02.SHT			

TITLE:  
**TERRACE VIEW POND IMPROVEMENTS  
 PROPOSED GRADING AND UTILITY PLAN**

PROJ. NO. 110256  
 DATE: 02/20/12  
 SHEET 6 OF 15

Proposed Seeding Mixes

NOTES:

1. ALL SEED MIXES SHALL BE MIXED WITH A GRANULAR FORM OF ENDOMYCORRHIZAL INOCULANT AT A RATE OF 40 LBS/ACRE.
2. OVERLAP SEEDING AS SHOWN ON SEEDING CROSS SECTION DETAIL.

Emergent Seeding +/- 8" above NWL and seeded on mudflat at NWL

Scientific Name	Common Name	Oz/Acre	Plant Height
<b>Grasses/Sedges</b>			
Carex comosa	Bristly sedge	5.0	2 - 4'
Carex lacustris	Lake sedge	0.5	2 - 4'
Carex lurida	Bottlebrush sedge	8.0	3'
Carex vulpinoidea	Brown fox sedge	12.0	2 - 3'
Eleocharis ovata	Blunt spike rush	2.0	1 - 2'
Juncus effusus	Common rush	2.0	1 - 4'
Leersia oryzoides	Rice cut grass	6.0	3 - 5'
Scirpus acutus	Hard stemmed bulrush	5.0	3 - 6'
Scirpus pungens	Chairmaker's rush	8.0	3'
Scirpus validus	Great bulrush	12.0	2 - 3'
<b>Forbs</b>			
Acorus clamus	Sweet flag	12.0	2 - 4'
Asclepias incarnata	Swamp milkweed	3.0	3 - 5'
Alisma spp.	Water plantain	4.0	3'
Decodon verticillatus	Swamp loosestrife	2.0	1.5'
Eupatorium maculatum	Spotted Joe-Pye weed	1.0	4'
Lobelia cardinalis	Cardinal flower	1.0	2 - 5'
Lobelia siphilitica	Great blue Lobelia	3.0	4'
Mimulus ringens	Monkey flower	2.0	2 - 4'
Peltandra virginica	Arrow arum	32.0	2 - 5'
Pontederia cordata	Pickering plant	20.0	1 - 3'
Sagittaria latifolia	Broad leaved arrowhead	4.0	1 - 4'
Sparganium americanum	American bur reed	4.0	2 - 5'
Sparganium eurycarpum	Common bur reed	8.0	2 - 5'
Verbena hastata	Blue vervain	2.0	3 - 6'
Zizania aquatica	Wild rice	16.0	3 - 7'

Temporary Cover Crop		lbs/acre	
Avena sativa	Oat	60	1 - 3'
Lolium multiflorum	Annual rye	6	1 - 3'

Note: Overlap the Emergent seed mix with the Shoreline Seed mix to insure complete vegetative coverage.

KANE-DUPAGE SOIL AND WATER CONSERVATION DISTRICT NOTES

1. UNLESS OTHERWISE INDICATED, ALL VEGETATIVE AND STRUCTURAL EROSION AND SEDIMENT CONTROL PRACTICES WILL BE CONSTRUCTED ACCORDING TO MINIMUM STANDARDS AND SPECIFICATIONS IN THE ILLINOIS URBAN MANUAL LATEST EDITION.
2. THE KANE-DUPAGE SOIL AND WATER CONSERVATION DISTRICT (KDSWCD) MUST BE NOTIFIED ONE WEEK PRIOR TO THE PRE-CONSTRUCTION CONFERENCE, ONE WEEK PRIOR TO COMMENCEMENT OF LAND DISTURBING ACTIVITIES, AND ONE WEEK PRIOR TO FINAL INSPECTION.
3. A COPY OF THE APPROVED EROSION AND SEDIMENT CONTROL PLAN SHALL BE MAINTAINED ON THE SITE AT ALL TIMES.
4. PRIOR TO COMMENCING THE LAND-DISTURBING ACTIVITIES IN AREAS OTHER THAN INDICATED ON THESE PLANS (INCLUDING BUT NOT LIMITED TO, ADDITIONAL PHASES OF DEVELOPMENT AND OFF-SITE BORROW OR WASTED AREAS) A SUPPLEMENTARY EROSION CONTROL PLAN SHALL BE SUBMITTED TO THE OWNER FOR REVIEW BY THE KDSWCD.
5. THE CONTRACTOR IS RESPONSIBLE FOR INSTALLATION OF ANY ADDITIONAL EROSION CONTROL MEASURES NECESSARY TO PREVENT EROSION AND SEDIMENTATION AS DETERMINED BY THE KDSWCD.
6. DURING DEWATERING OPERATION, WATER WILL BE PUMPED INTO SEDIMENT BASINS OR SILT TRAPS. DEWATERING DIRECTLY INTO FIELD TILES OR STORMWATER STRUCTURES IS PROHIBITED.
7. ALL EXCAVATION SHOULD BE ISOLATED FROM STREAM FLOW OR ADDITIONAL SEDIMENT CONTROL MEASURES UTILIZED.

Wet Prairie +/- 6" to 2' vertically above NWL

Scientific Name	Common Name	Oz/Acre	Plant Height
<b>Grasses/Sedges</b>			
Carex Cristatella	Crested oval sedge	2.0	2 - 3'
Carex Frankii	Bristly sedge	2.0	1 - 2'
Carex lurida	Bottlebrush sedge	6.0	3'
Carex vulpinoidea	Brown fox sedge	12.0	2 - 3'
Eleocharis ovata	Blunt spike rush	2.0	2'
Elymus virginicus	Virginia wild rye	24.0	2 - 5'
Glyceria striata	Fowl manna grass	3.0	2 - 4'
Juncus effusus	Common rush	2.0	4'
Juncus torreyi	Torrey's rush	0.5	1 - 3'
Leersia oryzoides	Rice cut grass	4.0	3 - 5'
Panicum virgatum	Switchgrass	16.0	5'
Scirpus atrovirens	Dark green bulrush	2.0	3 - 5'
Scirpus cyperinus	Wool grass	1.0	4 - 5'
Scirpus fluviatilis	River bulrush	0.5	3 - 7'
Scirpus validus	Great bulrush	12.0	2 - 3'
<b>Forbs</b>			
Alisma spp.	Water plantain	8.0	3'
Asclepias incarnata	Swamp milkweed	4.0	3 - 5'
Bidens spp.	Tickseed/bidens	4.0	3 - 5'
Helenium autumnale	Sneezeweed	6.0	3 - 5'
Mimulus ringens	Monkey flower	2.0	2 - 4'
Penthorum sedoides	Ditch stonecrop	2.0	1 - 3'
Polygonum pennsylvanicum	Pinkweed	8.0	1 - 3'
Rudbeckia subtomentosa	Sweet black-eyed Susan	6.0	3 - 5'
Sagittaria latifolia	Broad leaved Arrowhead	2.0	1 - 4'

Temporary Cover Crop		lbs/acre	
Avena sativa	Oat	60	1 - 3'
Lolium multiflorum	Annual rye	6	1 - 3'

Note: Overlap Wet-Mesic mix with the shoreline seed to insure complete vegetative coverage based on the actual experienced shoreline.

Prairie Buffer Seeding 1' above NWL to limit of buffer

Scientific Name	Common Name	Oz/Acre	Plant Height
<b>Grasses/Sedges</b>			
Andropogon gerardii	Big blue stem	32.0	4 - 8'
Bouteloua curtipendula	Sida oats gramma	20.0	2 - 4'
Calamagrostis canadensis	Blue joint grass	12.0	2 - 4'
Carex bicknellii or brevior	Sedge	2.0	1 - 2'
Elymus canadensis	Canada wild rye	32.0	2 - 5'
Glyceria striata	Fowl manna grass	12.0	2 - 4'
Juncus effusus	Common rush	6.0	4'
Koeleria pyramidata	June grass	4.0	1 - 2'
Leersia oryzoides	Rice cut grass	12.0	3 - 5'
Panicum virgatum	Switchgrass	12.0	5'
Spartina pectinata	Prairie cord grass	8.0	3 - 6'

Scientific Name	Common Name	Oz/Acre	Plant Height
<b>Forbs</b>			
Anemone cylindrical	Thimbleweed	1.0	2 - 3'
Asclepias tuberosa	Butterfly milkweed	5.0	3 - 5'
Aster ericoides	Heath aster	1.0	1 - 3'
Aster laevis	Smooth blue aster	2.0	3 - 5'
Aster novae-angliae	New England aster	1.0	3 - 6'
Coreopsis palmate	Prairie coreopsis	6.0	1 - 2'
Echinacea purpurea	Purple coneflower	10.0	3 - 5'
Eryngium yuccifolium	Rattlesnake master	6.0	3 - 5'
Kuhnia eupatorioides	False boneset	1.0	1 - 4'
Monarda fistulosa	Wild bergamot	3.0	2 - 5'
Parthenium integrifolium	Wild quinine	2.0	2 - 3'
Penstemon candidum	White prairie clover	3.0	2 - 4'
Pycnanthemum virginianum	Mountain mint	4.0	2 - 4'
Ratibida pinnata	Yellow coneflower	10.0	3 - 6'
Rudbeckia hirta	Black-eyed Susan	10.0	1 - 3'
Rudbeckia subtomentosa	Sweet Black-eyed Susan	2.0	3 - 5'
Tradescantia ohiensis	Spiderwort	8.0	2 - 4'
Vernonia spp.	Ironweed	2.0	3 - 5'

Temporary Cover Crop		lbs/acre	
Avena sativa	Oat	60	1 - 3'
Lolium multiflorum	Annual rye	6	1 - 3'

LAWN MIX

IDOT Class 1 - Lawn Mix

EROSION CONTROL NOTES

1. SOIL DISTURBANCE SHALL BE CONDUCTED IN SUCH A MANNER AS TO MINIMIZE EROSION. AREAS OF THE DEVELOPMENT SITE THAT ARE NOT TO BE GRADED SHALL BE PROTECTED FROM CONSTRUCTION TRAFFIC OR OTHER DISTURBANCE UNTIL FINAL SEEDING IS PERFORMED.
2. PROPERTIES AND CHANNELS ADJOIN THE DEVELOPMENT SITE SHALL BE PROTECTED FROM EROSION AND SEDIMENTATION.
3. SOIL EROSION AND SEDIMENT CONTROL FEATURES SHALL BE CONSTRUCTED PRIOR TO THE COMMENCEMENT OF HYDROLOGIC DISTURBANCE OF UPLAND AREAS.
4. DISTURBED AREAS SHALL BE STABILIZED WITH TEMPORARY OR PERMANENT MEASURES WITHIN SEVEN (7) CALENDAR DAYS FOLLOWING THE END OF ACTIVE HYDROLOGIC DISTURBANCE.
5. ALL STORM SEWERS THAT ARE OR WILL BE FUNCTIONING DURING CONSTRUCTION SHALL BE PROTECTED BY AN APPROPRIATE SEDIMENT CONTROL MEASURE.
6. IF DEWATERING SERVICES ARE USED, ADJOINING PROPERTIES AND DISCHARGE LOCATIONS SHALL BE PROTECTED FROM EROSION. DISCHARGES SHALL BE ROUTED THROUGH AN EFFECTIVE SEDIMENT CONTROL MEASURE (E.G., SEDIMENT TRAP, SEDIMENT BASIN, OR OTHER APPROPRIATE MEASURES).
7. ALL TEMPORARY SOIL EROSION AND SEDIMENT CONTROL MEASURES SHALL BE REMOVED WITHIN THIRTY (30) DAYS AFTER FINAL SITE STABILIZATION IS ACHIEVED OR AFTER THE TEMPORARY MEASURES ARE NO LONGER NEEDED. TRAPPED SEDIMENT AND OTHER DISTURBED SOIL AREAS SHALL BE PERMANENTLY STABILIZED.
8. SOIL STOCKPILES SHALL NOT BE LOCATED IN A FLOOD-PRONE AREA OR A DESIGNATED BUFFER PROTECTING WATERS OF THE UNITED STATES OR ISOLATED WATERS OF MCHENRY COUNTY.
9. THE CONTRACTOR SHALL PROVIDE ADEQUATE RECEPTACLES FOR THE DEPOSITION OF ALL CONSTRUCTION MATERIAL DEBRIS GENERATED DURING THE DEVELOPMENT PROCESS. THE CONTRACTOR SHALL NOT CAUSE OR PERMIT THE DUMPING, DEPOSITING, DROPPING, THROWING, DISCARDING OR LEAVING OF CONSTRUCTION MATERIAL DEBRIS UPON OR INTO ANY DEVELOPMENT SITE, CHANNEL, WATER OF THE U.S. OR ISOLATED WATERS OF MCHENRY COUNTY. THE CONTRACTOR SHALL MAINTAIN THE DEVELOPMENT SITE FREE OF CONSTRUCTION MATERIAL DEBRIS.
10. ALL TEMPORARY AND PERMANENT EROSION AND SEDIMENT CONTROL MEASURES SHALL BE MAINTAINED IN AN EFFECTIVE WORKING CONDITION.

STAGING NOTES

**CHRISTOPHER B. BURKE ENGINEERING, LTD.**  
 9575 W. Higgins Road, Suite 600  
 Rosemont, Illinois 60018  
 (847) 823-0500

CLIENT:  
  
**VILLAGE OF LOMBARD**

NO.	DATE	NATURE OF REVISION	CHKD.	MODEL:
FILE NAME	K:\Lombard\110256\CIVIL\EC\NOT_110256.SHT			

TITLE:	PROJ. NO.
<b>TERRACE VIEW POND IMPROVEMENTS</b>	110256
<b>EROSION CONTROL NOTES</b>	
DATE:	02/20/12
SHEET 7	OF 16

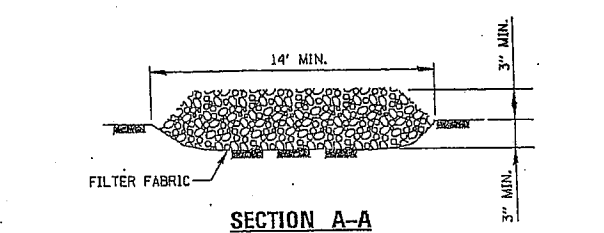
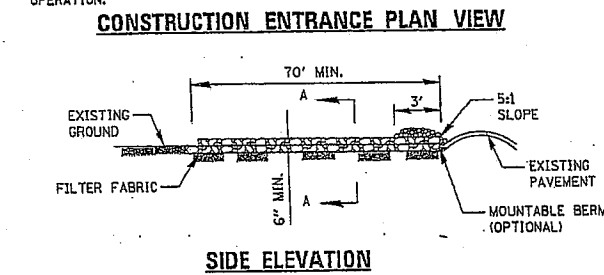
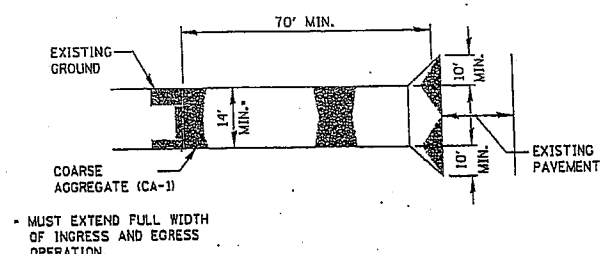
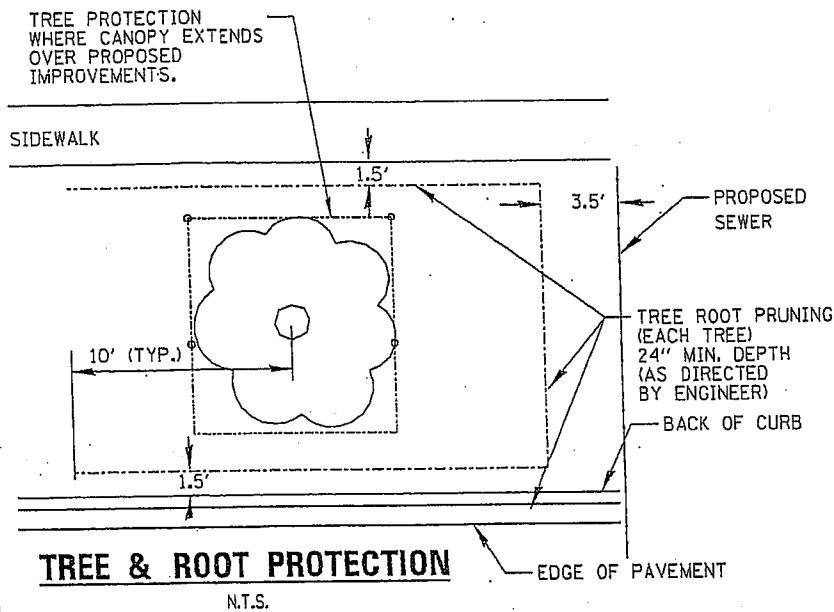

NOTES:

- FILTER FABRIC SHALL MEET THE REQUIREMENTS OF MATERIAL SPECIFICATION 592 GEOTEXTILE, TABLE 1 OR 2, CLASS I, II OR IV AND SHALL BE PLACED OVER THE CLEARED AREA PRIOR TO THE PLACING OF ROCK.
- ROCK OR RECLAIMED CONCRETE SHALL MEET ONE OF THE FOLLOWING IDOT COARSE AGGREGATE GRADATION, CA-1, CA-2, CA-3 OR CA-4 AND BE PLACED ACCORDING TO CONSTRUCTION SPECIFICATION 25 ROCKFILL USING PLACEMENT METHOD 1 AND CLASS III COMPACTION.
- ANY DRAINAGE FACILITIES REQUIRED BECAUSE OF WASHING SHALL BE CONSTRUCTED ACCORDING TO MANUFACTURERS SPECIFICATIONS.

### STABILIZED CONSTRUCTION ENTRANCE

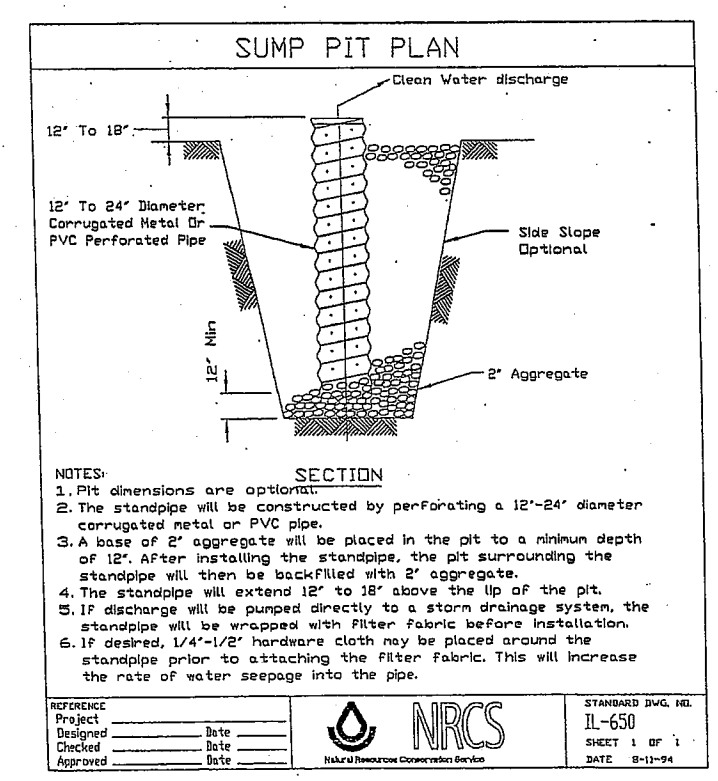
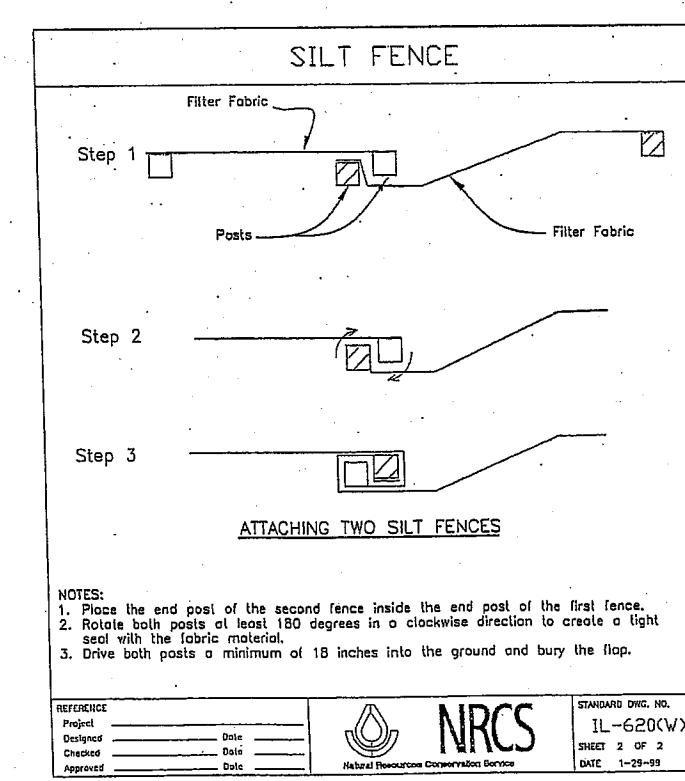
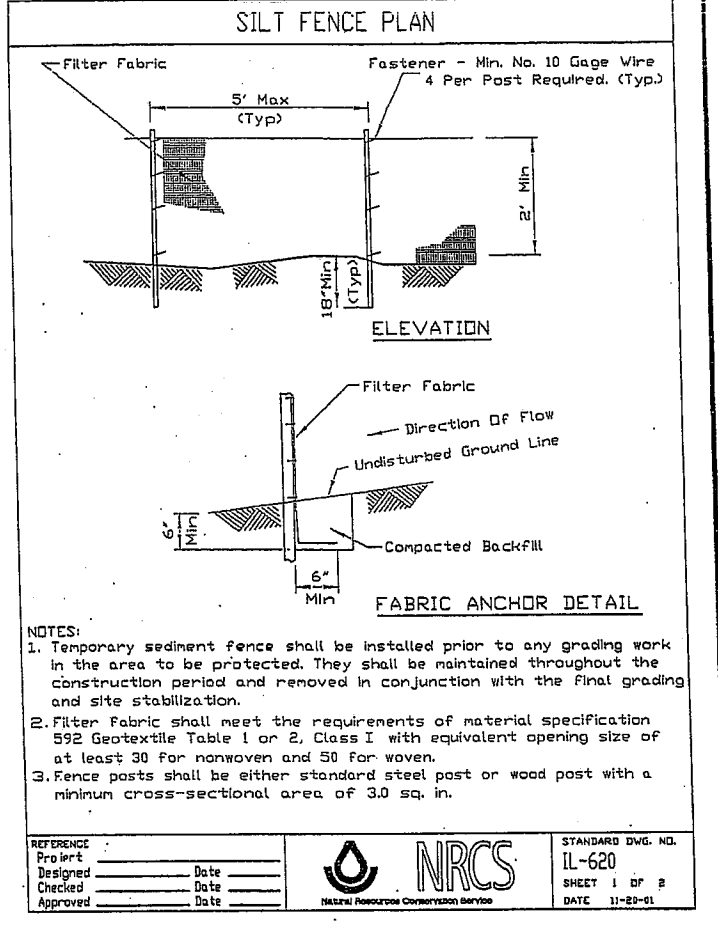
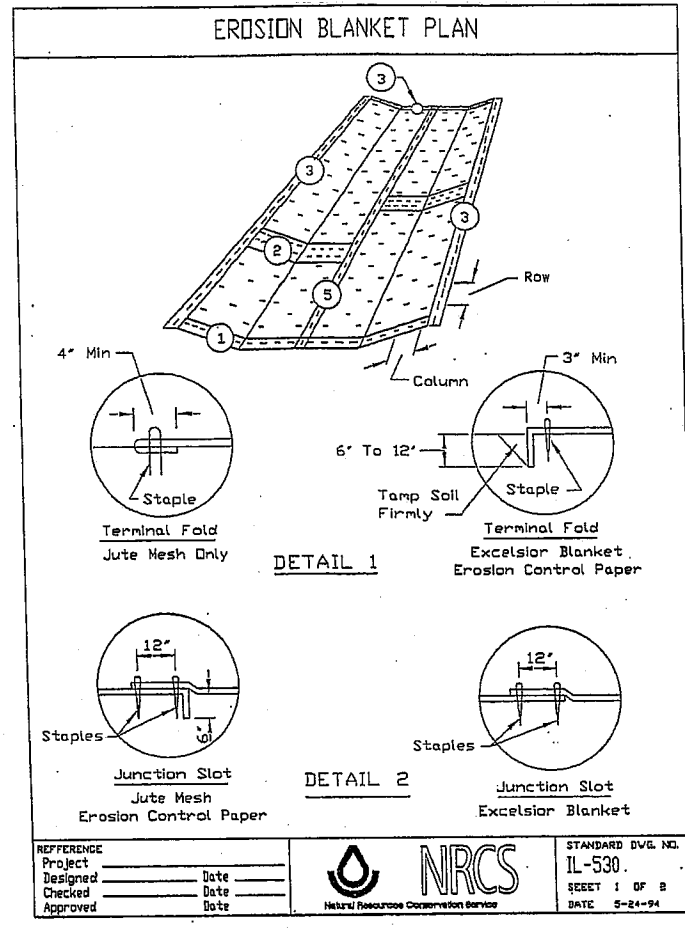
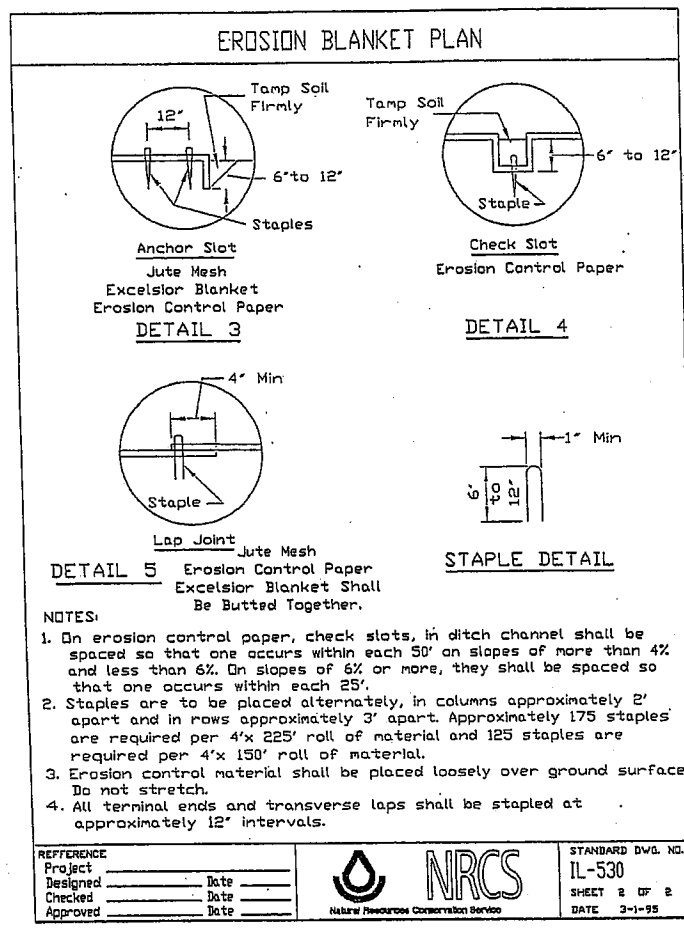

**CB** CHRISTOPHER B. BURKE ENGINEERING, LTD.  
 9575 W. Higgins Road, Suite 600  
 Rosemont, Illinois 60018  
 (847) 823-0500

CLIENT: **VILLAGE OF LOMBARD**

NO.	DATE	NATURE OF REVISION	CHKD.	MODEL:	Default
FILE NAME	H:\Lombard\110256\CTV\NECPDET_110256.SHT				

TITLE: **TERRACE VIEW POND IMPROVEMENTS**  
**EROSION CONTROL DETAILS**

PROJ. NO. 110256  
 DATE: 02/20/12  
 SHEET 8 OF 16



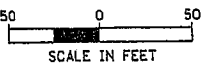
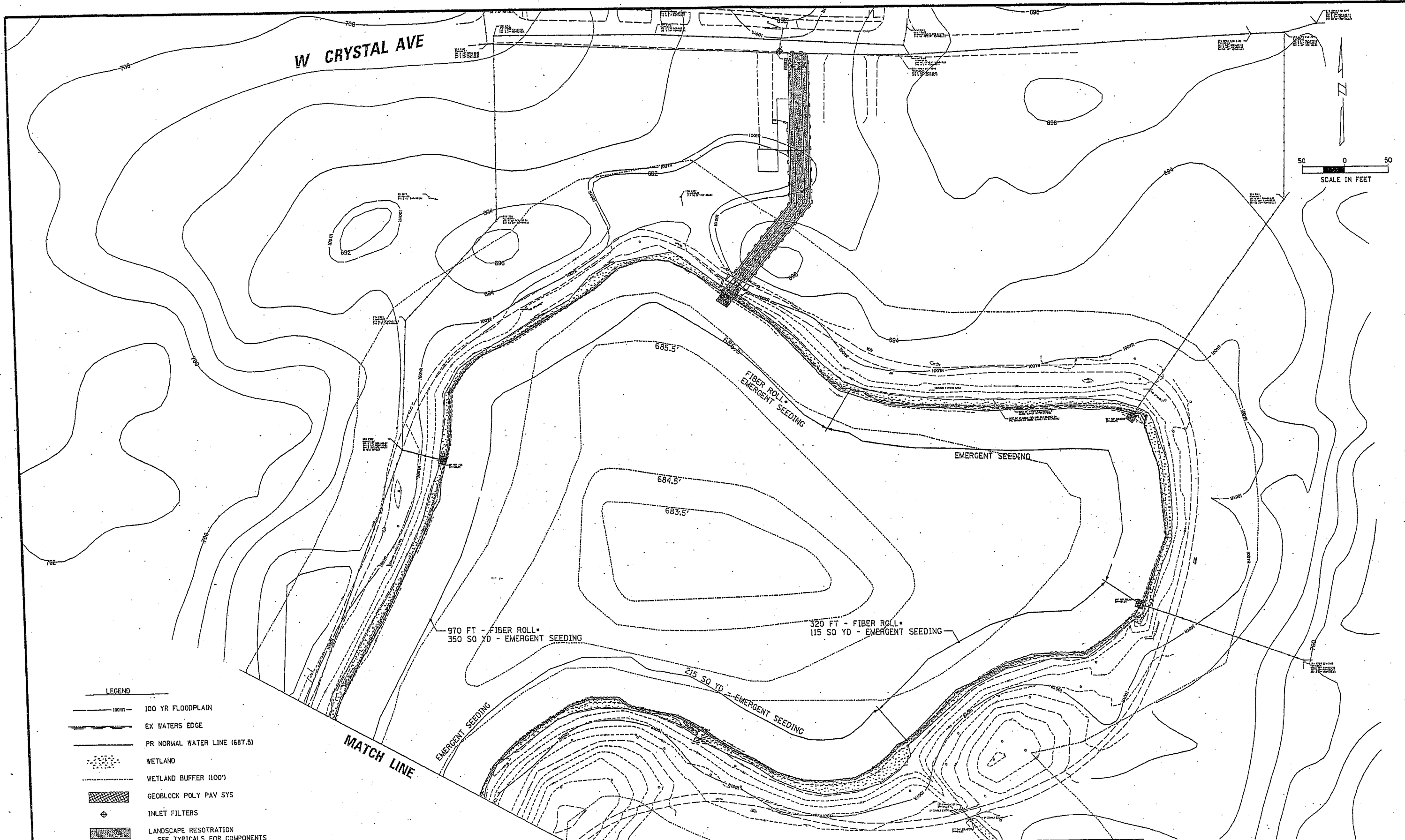

- LEGEND**
- 100 YR FLOODPLAIN
  - EX WATERS EDGE
  - PR NORMAL WATER LINE (687.5)
  - WETLAND
  - WETLAND BUFFER (100')
  - GEOBLOCK POLY PAV SYS
  - INLET FILTERS
  - LANDSCAPE RESOTRATION  
SEE TYPICALS FOR COMPONENTS

**CHRISTOPHER B. BURKE ENGINEERING, LTD.**  
 9575 W. Higgins Road, Suite 600  
 Rosemont, Illinois 60018  
 (847) 823-0500

CLIENT:  
  
**VILLAGE OF LOMBARD**

NO.	DATE	NATURE OF REVISION	CHKD.	MODEL:
FILE NAME	H:\Lombard\110256\CIVIL\NEW_110256-01.SHT			

DSGN.	BLL	TITLE:	PROJ. NO.	110256
DWN.		<b>TERRACE VIEW POND IMPROVEMENTS WETLAND, BUFFER &amp; RIPARIAN PLAN</b>	DATE:	02/20/12
CHKD.	JMA		SHEET 9	OF 16
SCALE:	50'			
PLOT DATE:	2/21/2012			
CAD USER:	mvdarar			
	Default			

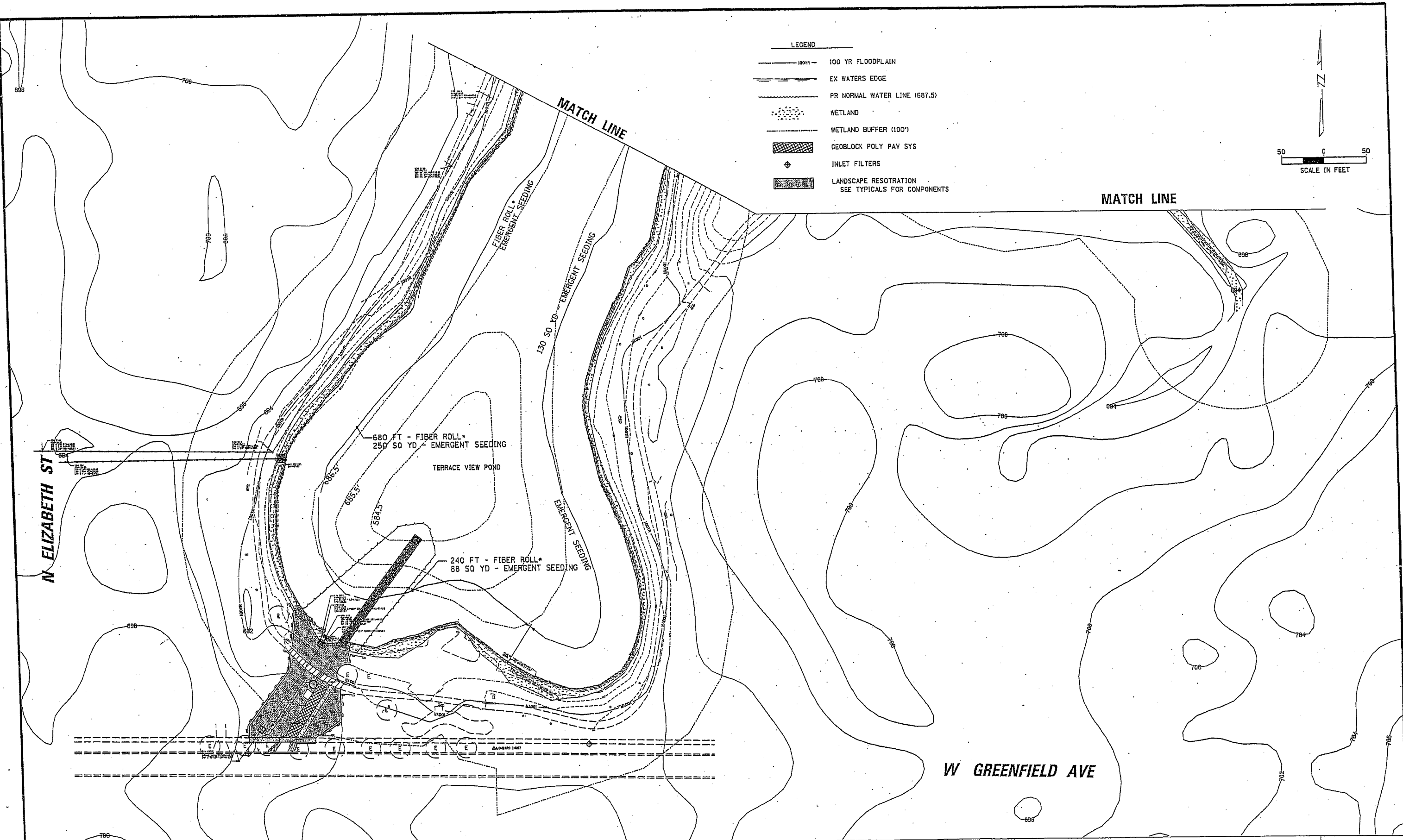

- LEGEND**
- 100 YR FLOODPLAIN
  - EX WATERS EDGE
  - PR NORMAL WATER LINE (687.5)
  - WETLAND
  - WETLAND BUFFER (100')
  - GEOBLOCK POLY PAV SYS
  - INLET FILTERS
  - LANDSCAPE RESOTRATION  
SEE TYPICALS FOR COMPONENTS

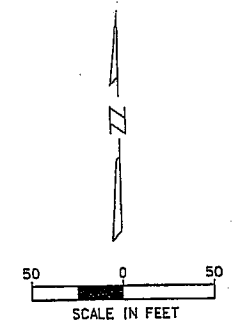

N ELIZABETH ST

W GREENFIELD AVE



**CHRISTOPHER B. BURKE ENGINEERING, LTD.**  
 9575 W. Higgins Road, Suite 600  
 Rosemont, Illinois 60018  
 (847) 823-0500

CLIENT:



**VILLAGE OF LOMBARD**

NO.	DATE	NATURE OF REVISION	CHKD.	MODEL:
FILE NAME		H:\Lombard\110256\CIVIL\ENVY_110256-02.SHT		

DSCN.	BLL
DWN.	
CHKD.	JMA
SCALE:	50'
PLDT DATE:	2/21/2012
CAD USER:	mvdarar

TITLE:  
**TERRACE VIEW POND IMPROVEMENTS  
 WETLAND, BUFFER & RIPARIAN PLAN**

PROJ. NO. 110256  
 DATE: 02/20/12  
 SHEET 10 OF 15

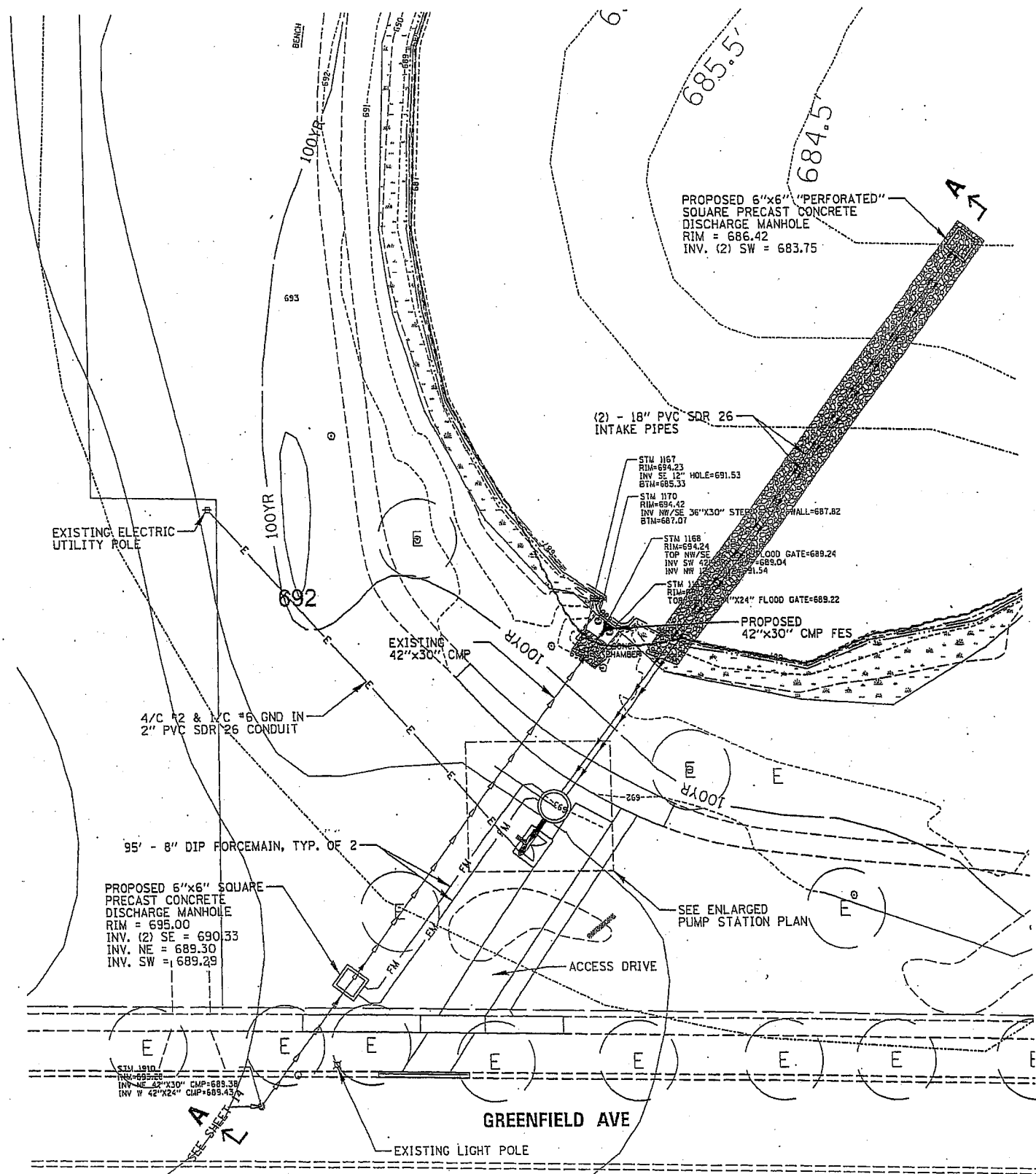

**OVERALL PUMP STATION PLAN**

SCALE: 22"x34" PAPER: 1" = 20'

11"x17" PAPER: 1" = 40'

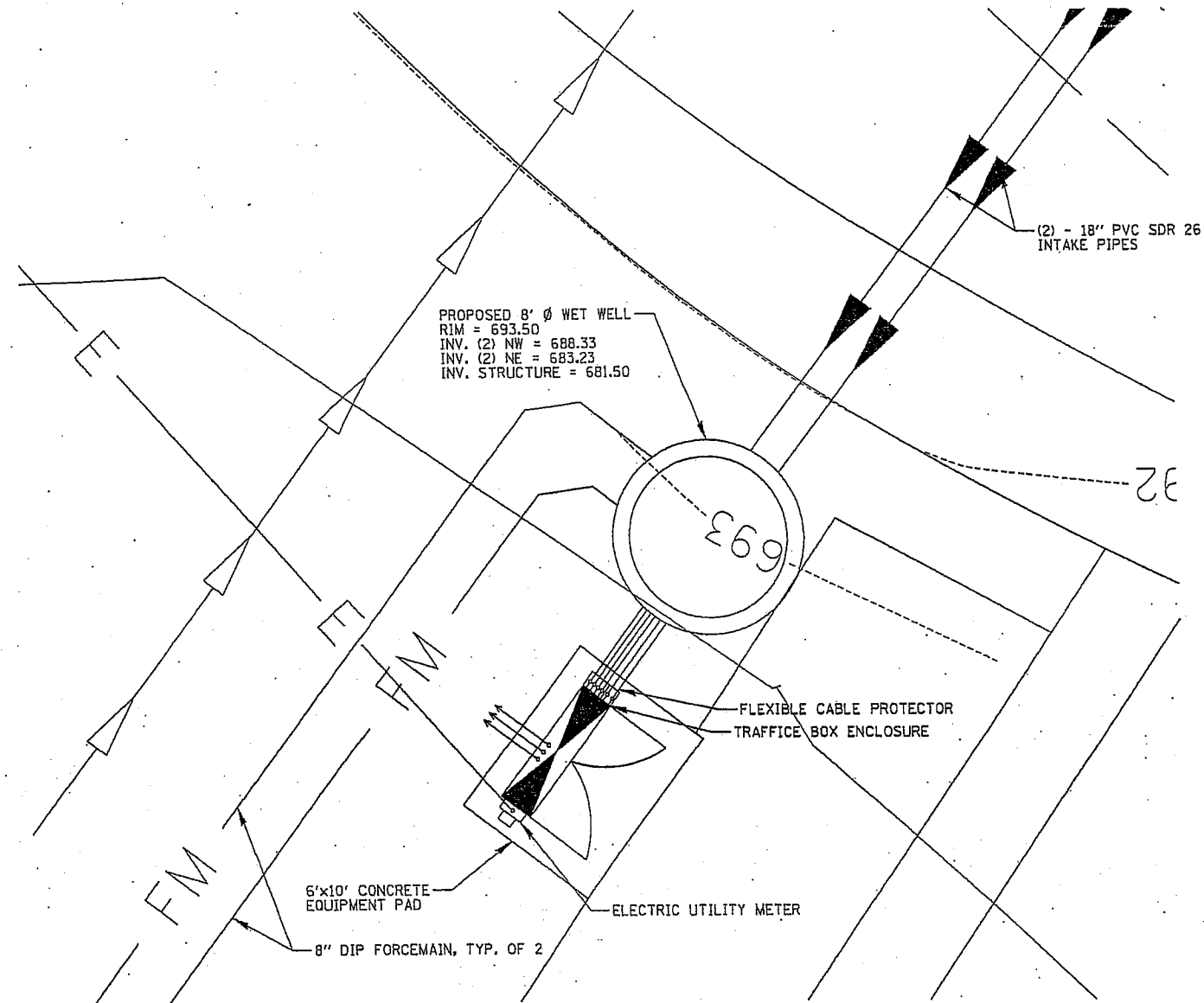

**ENLARGED PUMP STATION PLAN**

SCALE: 22"x34" PAPER: 1/4" = 1'

11"x17" PAPER: 1/8" = 1'



**CHRISTOPHER B. BURKE ENGINEERING, LTD.**  
 9575 W. Higgins Road, Suite 600  
 Rosemont, Illinois 60018  
 (847) 823-0500

CLIENT:



**VILLAGE OF LOMBARD**

NO.	DATE	NATURE OF REVISION	CHKD.	MODEL:
FILE NAME	H:\Lombard\110256\Mech\110256-PSL.SHT			

TITLE:	PROJ. NO.
<b>TERRACE VIEW POND IMPROVEMENTS STORM WATER PUMP STATION PROPOSED SITE PLAN</b>	110256
DATE:	
02/20/12	
SHEET 11 OF 16	

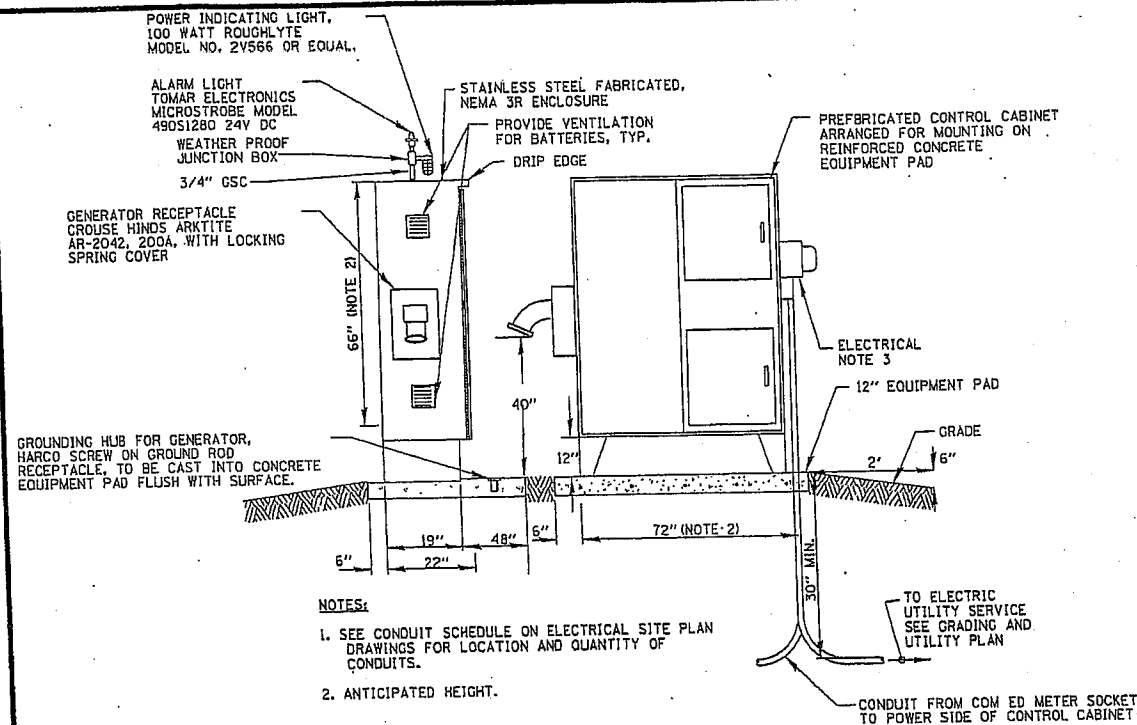

**TRAFFIC BOX ENCLOSURE (TBE)**

N.T.S.

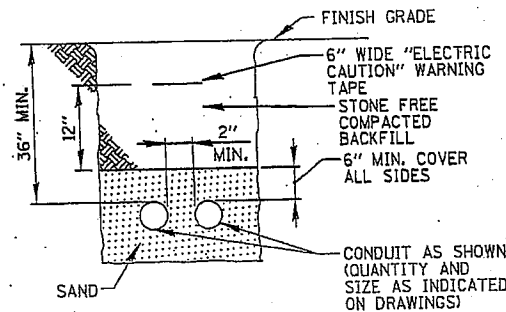

**DIRECT BURIED CONDUIT DETAIL**

N.T.S.

PANELBOARD SCHEDULE (PB-1)						
60 AMP BUS RATING 120/240 VOLTS		22,000A S.C. RATING 1 PH. 3 WIRE 60 HZ.			12 SPACES SURFACE MOUNTED	
DESCRIPTION	LOAD W	C/B AMP POLES	CIRCUIT NOS.	C/B AMP POLES	LOAD W	DESCRIPTION
MAIN CIRCUIT BREAKER 60 AMP/2 POLE						
BATTERY CHARGER	150	20A	1	2	400	VENT FANS FORCE AIR HEATER
CONTROL CIRCUIT		20A	3	4	20A	POWER MONITOR
SPARE		20A	5	6	20A	120V GFI RECEPTACLE
SPARE		20A	7	8	20A	SUMP PUMP
SPARE		20A	9	10	20A	SPARE
SPARE		20A	11	12	20A	SPARE

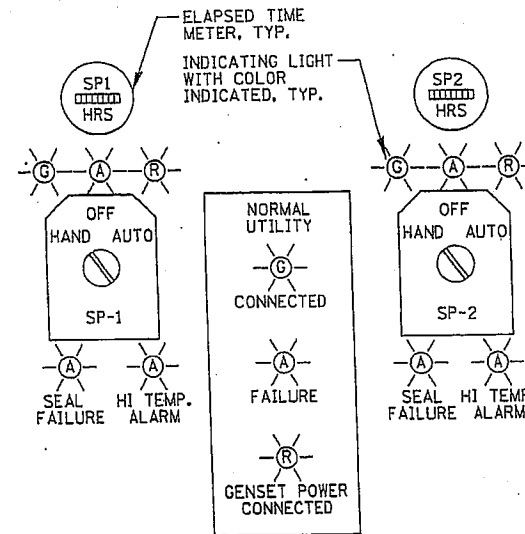

**TYPICAL CONTROL LAYOUT**

N.T.S.

9"Ø GREEN POLYMER CONCRETE  
ACCESS WELL WITH "GROUND" LOGO  
ENGRAVED IN COVER, TYP. OF 3

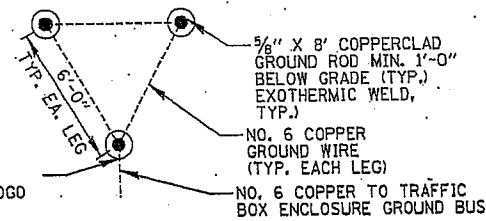

**GROUND FIELD DETAIL (TYP.)**

N.T.S.

**GROUNDING NOTES**

- FURNISH AND INSTALL A GROUND FIELD AS SHOWN. GROUNDING CONDUCTOR SHALL BE INSTALLED 1-FT. MINIMUM BELOW GROUND.
- GROUND ALL EXPOSED METAL WORK SUCH AS HATCHES, METAL CABINETS AND EQUIPMENT FRAMES, ETC. CONNECTIONS TO HATCHES, AND OTHER METAL WORK SHALL BE FUSION WELDED. CONNECTIONS TO THE GALVANIZED EQUIPMENT AND TO EQUIPMENT WHICH MAY BE REMOVED FOR MAINTENANCE SHALL BE MADE WITH BOLTED CLAMP TYPE CONNECTIONS OF SOLID COPPER, WELDED TO THE GROUNDING CONNECTOR.
- UNLESS OTHERWISE INDICATED, THE MINIMUM SIZE OF SYSTEM GROUNDING CONDUCTOR SHALL BE NO. 6 AWG.
- EACH CONDUIT RUN SHALL BE GROUNDED TO THE COMMON GROUNDING BUS IN THE PANEL WHERE IT ORIGINATES. THE MINIMUM SIZE OF GROUNDING CONDUCTOR SHALL BE PER NEC SECTION 250.122 OR AS OTHERWISE SHOWN ON THE DRAWINGS.
- GROUNDING RODS SHALL BE COPPERWELD, MINIMUM 5/8-IN. DIAMETER X 8-FT. LONG. CABLE-TO-CABLE AND CABLE-TO-GROUND ROD CONNECTIONS SHALL BE MADE BY THE FUSION WELDING PROCESS.

**ELECTRICAL SYMBOLS**

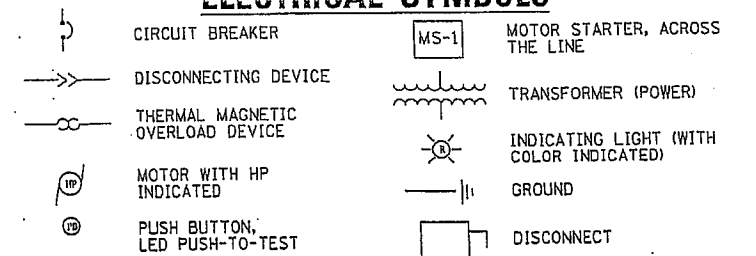

**ELECTRICAL ABBREVIATIONS**

- |                                    |   |
|------------------------------------|---|
| FVR - FULL VOLTAGE REVERSING       | NEUT - NEUTRAL                            |
| FVNR - FULL VOLTAGE NON-REVERSING  | MS-1 - MOTOR STARTER, ACROSS-<br>THE LINE |
| GRND - GROUND                      | ATS - AUTOMATIC TRANSFER SWITCH           |
| PB - PUSH BUTTON, LED PUSH-TO-TEST | HOA - HAND-OFF-AUTO SELECTOR SWITCH       |
|                                    | ETM - ELAPSED TIME METER                  |
|                                    | UH - UNIT HEATER                          |

**ELECTRICAL NOTES**

- POWER/CONTROL CABLES INTEGRALLY WIRED AND PROVIDED WITH RESPECTIVE PUMPING UNITS, AND/OR FLOATS AND TRANSDUCER. CONTRACTOR TO COORDINATE. CABLE LENGTHS TO BE PROVIDED AS REQUIRED. CABLE LENGTHS TO BE CONTINUOUS AND UNSPLICED.
- PROVIDE SEPARATE CONDUITS FOR CABLING AS NOTED.
- COMED METER. (METER FURNISHED BY COMED AND INSTALLED BY CONTRACTOR. INSTALLATION PER COMED REQUIREMENTS).
- THE CONTRACTOR SHALL BE RESPONSIBLE FOR ANY/ALL NECESSARY COORDINATION FOR THE REQUIRED ELECTRICAL SERVICE.
- EXACT LOCATION OF EMBEDDED AND/OR BURIED CONDUITS SHALL BE THE RESPONSIBILITY OF THE CONTRACTOR SUBJECT TO THE REVIEW OF THE OWNER'S REPRESENTATIVE. ACTUAL NUMBER OF CONDUITS SHALL BE AS REQUIRED.
- TRIP RATINGS SHOWN OR SPECIFIED ARE FOR MOTOR HORSEPOWERS ANTICIPATED. SELECTED EQUIPMENT HORSEPOWER MAY BE LARGER OR SMALLER THAN INDICATED. CONTRACTOR SHALL PROVIDE THE NECESSARY TRIP RATINGS AS REQUIRED BY N.E.C. FOR THE ACTUAL EQUIPMENT PROVIDED.
- EQUIPMENT PADS TO BE MINIMUM 6" ABOVE GRADE.
- GROUND RODS SHALL BE USED FOR GROUNDING: MINIMUM SIZE SHALL BE 5/8" DIA., 8 FEET LONG. INSTALLATION AND GROUND RESISTANCE SHALL BE IN ACCORDANCE WITH SPECIFICATIONS AND MEET OWNER APPROVAL. SEE GROUNDING NOTES FOR ADDITIONAL DETAILS.
- UNLESS OTHERWISE SPECIFIED OR SHOWN ON THE DRAWINGS, USE RIGID GALVANIZED STEEL (RGS) CONDUIT. ALL CONDUIT SHALL BE RIGIDLY SUPPORTED.
- TIME DELAY RELAYS AND MOTOR STARTERS FOR EACH PUMP SHALL BE PROVIDED WITH A (0-60 SECOND) ADJUSTABLE TIME DELAY RELAY. RELAYS SHALL BE ADJUSTABLE IN 5 SECOND INTERVALS.
- THE CONTRACTOR SHALL FURNISH AND INSTALL COMPLETE ALL ELECTRICAL DEVICES, CONDUIT AND WIRING AND CONTROLS AS REQUIRED FOR THE UNATTENDED AND AUTOMATIC OPERATION OF THE PUMP STATION, AS SPECIFIED.
- PROVIDE GFCI PROTECTION FOR ALL POWER RECEPTACLES.
- THE ELECTRICAL DEVICES/COMPONENTS/CONTROLLER MUST BE LISTED FOR USE BY A NATIONALLY RECOGNIZED TESTING LABORATORY.
- AS BUILT DRAWINGS SHALL BE PROVIDED INCLUDING FIELD VERIFICATION BY THE CONTRACTOR.
- INSTALLATION SHALL COMPLY WITH NATIONAL ELECTRICAL CODE REQUIREMENT FOR CLASS I, DIVISION 1, GROUP D.
- STANDBY GENERATOR TO BE OF THE NATURAL GAS DRIVEN TYPE.
- PROVIDE 3-PHASE FAILURE MONITOR AS PART OF THE PUMP CONTROLLER TO DROP OUT PUMPS UPON LOSS OF ANY PHASE LEG.
- PLUG-IN RECEPTACLE FOR PORTABLE STANDBY ELECTRIC GENERATOR SET. CONTRACTOR TO COORDINATE PIN CONFIGURATION WITH OWNER. (PORTABLE GENERATOR IS NOT PART OF THIS CONTRACT).

CLIENT:



**VILLAGE OF LOMBARD**

NO.	DATE	NATURE OF REVISION	CHKD.	MODEL:
				Default
FILE NAME		N:\Lombard\110256\Wach\110256-PS2.SHT		

TITLE:

**TERRACE VIEW POND IMPROVEMENTS  
STORM WATER PUMP STATION  
PUMP STATION DETAILS - 1**

PROJ. NO. 110256

DATE:

02/20/12

SHEET 12 OF 15

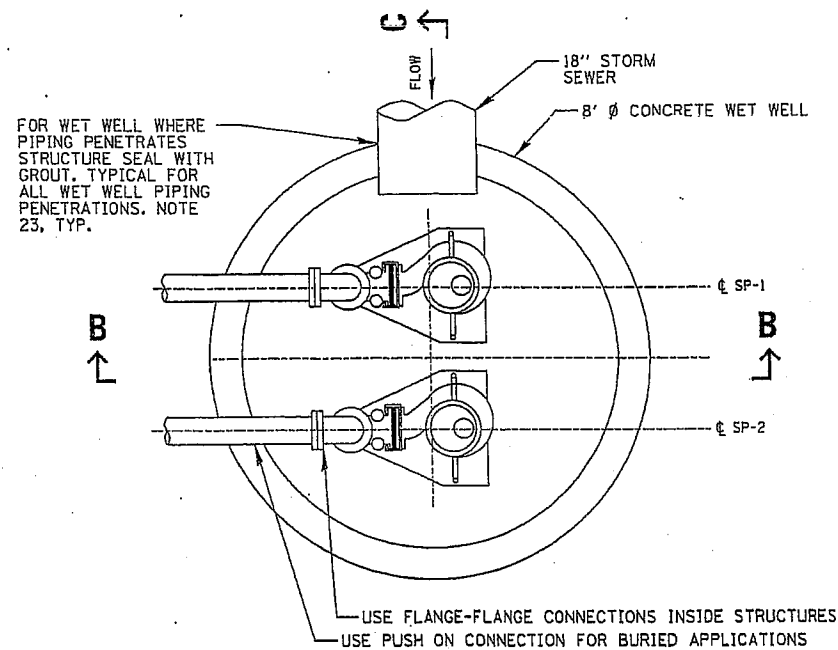

**PLAN VIEW**  
N.T.S.

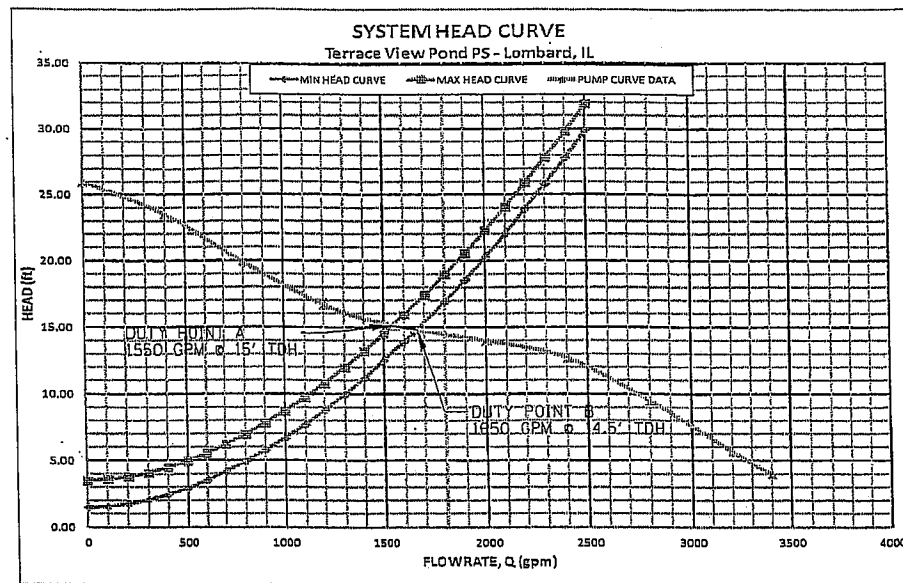

**PUMPS (SP-1 & SP-2) SYSTEM HEAD CURVE**

NOTE: PUMPS DESIGNATED SP-1 & 2 SHALL BE CAPABLE OF MEETING THE RATED CONDITIONS INDICATED. PUMPS SHALL ALSO BE CAPABLE OF OPERATING OVER THE OPERATING RANGE INDICATED.

**LIFT STATION NOTES**

1. ANY AND ALL DEWATERING REQUIRED DURING CONSTRUCTION SHALL BE THE RESPONSIBILITY OF THE CONTRACTOR.
2. ORIENTATION OF PIPING, DUCTS/CONDUITS, EQUIPMENT ETC. MAY VARY. CONTRACTOR TO COORDINATE WITH EQUIPMENT LOCATIONS SHOWN ON OTHER SHEETS.
3. DIMENSIONING SHOWN ON THIS DRAWING IS NOT TO SCALE (N.T.S.). DO NOT SCALE THIS DRAWING.
4. LOCATION ORIENTATION AND NUMBER OF EMBEDDED AND/OR BURIED DUCTS & CONDUITS SHALL BE THE RESPONSIBILITY OF THE CONTRACTOR. MINIMUM NUMBER OF DUCTS/CONDUITS ARE SHOWN ON DUCT/CONDUIT PLAN. CABLES INTEGRALLY WIRED AND PROVIDED WITH PUMPS, FLOATS, AND TRANSDUCER TO BE OF SUFFICIENT LENGTH TO CONNECT TO CONTROLLER WITHOUT SPLICING, UNLESS SPECIFICALLY SHOWN ON DRAWINGS.
5. CONTRACTOR TO COORDINATE POSITION AND SIZE OF PUMP STATION HATCHES TO ALLOW FOR PUMP REMOVAL.
6. USE OF PUMPS SUPPLIED UNDER THIS CONTRACT FOR THE PURPOSE OF DEWATERING DURING CONSTRUCTION, WILL NOT BE PERMITTED.
7. REINFORCED FLAT SLAB TOP TO BE A MINIMUM OF 10" THICK. REBARS TO BE #5 @ 12" ON CENTER BOTHWAYS, TOP AND BOTTOM, AND FULL LENGTH BARS EQUAL IN NUMBER TO THOSE BARS CUT AND LAY IN THE SAME DIRECTION AS THOSE CUT. ALL BARS TO BE EPOXY COATED. PROVIDE ADDITIONAL BARS AT CORNERS OF HATCH OPENINGS.
8. PROVIDE AUTOMATIC ALTERNATOR TO ALTERNATE OPERATION OF PUMPS.
9. HATCHES SHALL BE ALUMINUM WITH BRONZE AND/OR 316 STAINLESS STEEL TRIM. LOAD RATING SHALL BE H-20. CONTRACTOR TO COORDINATE HATCH SIZE AND ORIENTATION AS REQUIRED.
10. PROVIDE SEPARATE DUCTS FOR EACH PUMP POWER CABLE. PROVIDE SEPARATE DUCT FOR PUMP CONTROL CABLES. PROVIDE SEPARATE DUCT FOR FLOAT AND TRANSDUCER CONTROL CABLES.
11. CONTRACTOR RESPONSIBLE FOR EQUIPMENT ORIENTATION.
12. PROVIDE PLASTIC COATED ANCHOR FOR FLOAT SWITCH TO PREVENT MOVEMENT.
13. ALL FASTENERS TO BE STAINLESS STEEL.
14. EXTERIOR AND INTERIOR SURFACES OF WET WELL STRUCTURE BELOW GRADE TO BE COATED AS FOLLOWS: EXTERIOR WITH BITUMINOUS WATER PROOFING AND INTERIOR WITH COAL TAR EQUAL TO TNEPEC SERIES 46-465 H.B. TNEPCOL. TWO COATINGS, EACH 8 MILS THICK (DRY) TO BE PROVIDED.
15. SEE OPERATION OF SYSTEM FOR DETAILS OF PUMP STATION OPERATION. REFER TO EQUIPMENT SPECIFICATION SHEET.
16. THE MECHANICAL FLOAT SYSTEM SHALL OPERATE FOR THE LEVELS INDICATED.
17. PROVIDE CONDENSATION HEATER AND THERMOSWITCH FOR CONTROLLER. HEATER SIZE TO BE COORDINATED BY CONTRACTOR.
18. PROVIDE A DUAL 20 AMP GFCI CONVENIENCE OUTLET LOCATED WITHIN THE PUMP CONTROLLER.
19. HATCHES SHALL BE GASKETED, ODOR RESISTANT, AND LOCKABLE.
20. SAFETY GRATING SHALL SPAN THE ENTIRE OPENING OF EACH HATCH. A SINGLE SAFETY GRATE SPANNING ALL HATCHES WILL NOT BE ACCEPTABLE. GRATING SHALL BE CAPABLE OF SUPPORTING 300 PSF.
21. WET WELL BARREL LENGTH AS REQUIRED. CONTRACTOR TO COORDINATE SUCH THAT JOINTS DO NOT FALL AT LOCATION(S) OF PIPE PENETRATIONS.
22. PROVIDE SOLID SLEEVE COUPLINGS OR OFFSET FITTINGS AS REQUIRED TO ACCOMMODATE PIPING ALIGNMENTS BETWEEN WET WELL AND VALVE VAULT.
23. PROVIDE WATER TIGHT JOINT BY FILLING ANNULAR SPACE BETWEEN PIPE OPENING AND PIPE WITH SEALING GROUT. TYPICAL FOR ALL PIPING WHICH PENETRATES WET WELL AND/OR VALVE VAULT STRUCTURE.

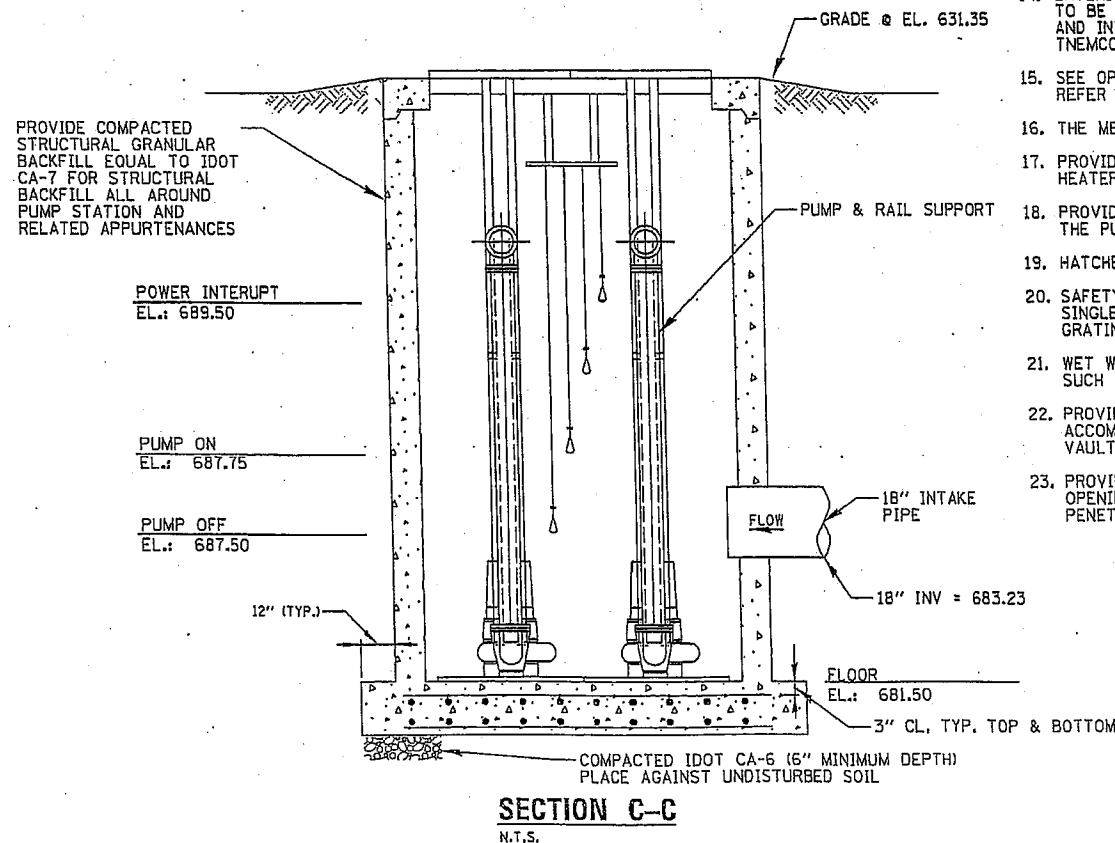
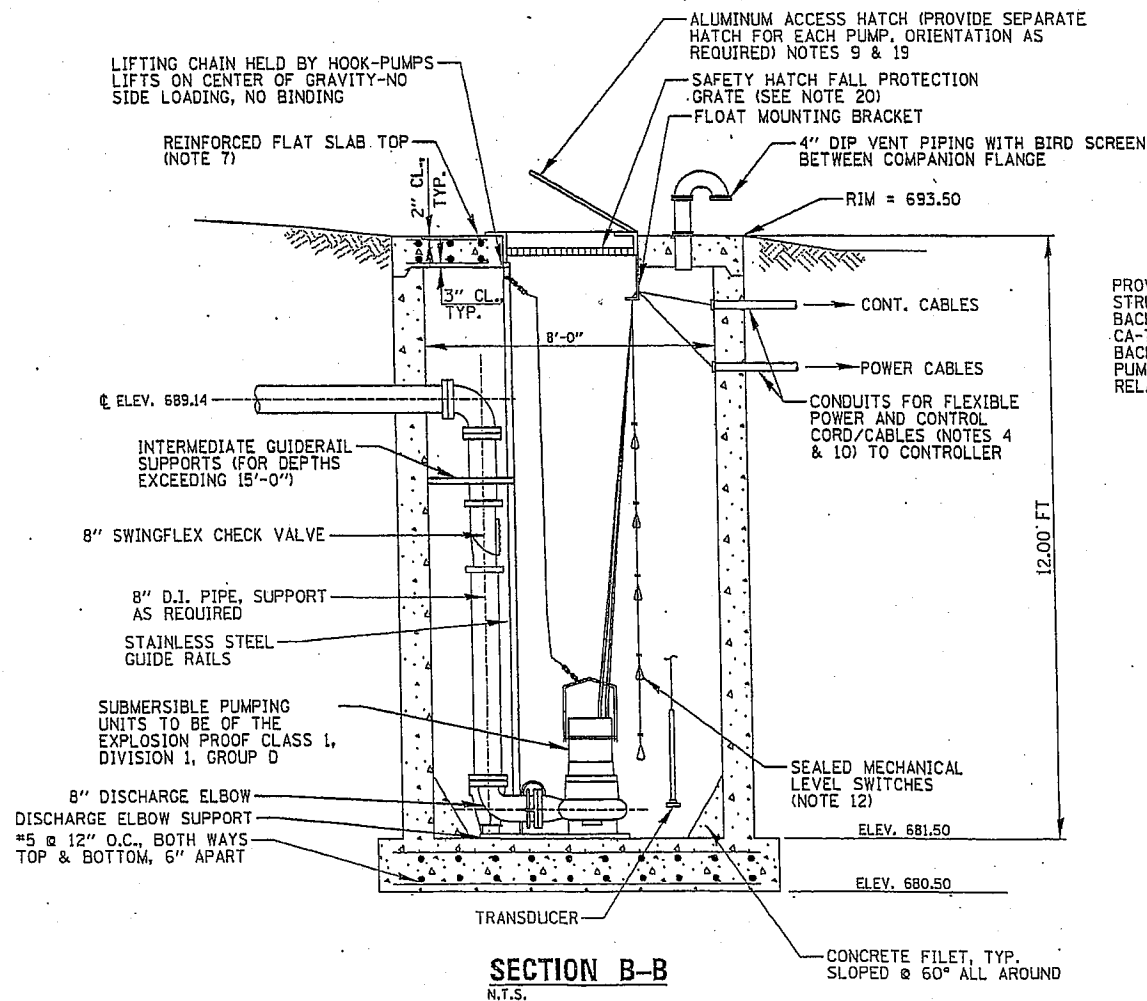

**CHRISTOPHER B. BURKE ENGINEERING, LTD.**  
9575 W. Higgins Road, Suite 600  
Rosemont, Illinois 60018  
(847) 823-0500

CLIENT:



**VILLAGE OF LOMBARD**

NO.	DATE	NATURE OF REVISION	CHKD.	MODEL:
				Default

DSGN.	
DWN.	
CHKD.	
SCALE:	NTS
PLOT DATE:	2/21/2012
CAD USER:	mvdorfer

TITLE:

**TERRACE VIEW POND IMPROVEMENTS  
STORM WATER PUMP STATION  
PUMP STATION DETAILS - 2**

PROJ. NO.	110256
DATE:	02/20/12
SHEET	13 OF 16

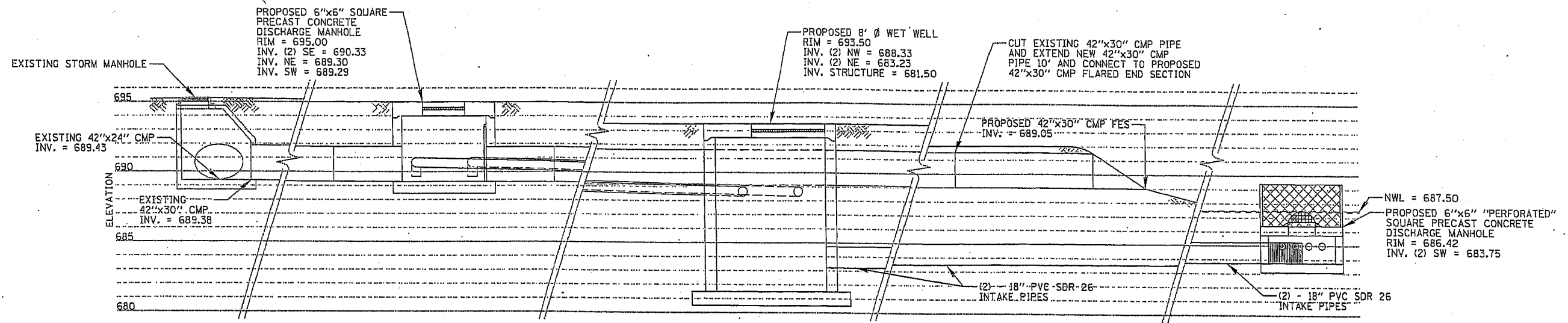

**SECTION A-A: PUMP STATION PROFILE**

SCALE: 22"x34" PAPER: 1/4" = 1'

11"x17" PAPER: 1/8" = 1'

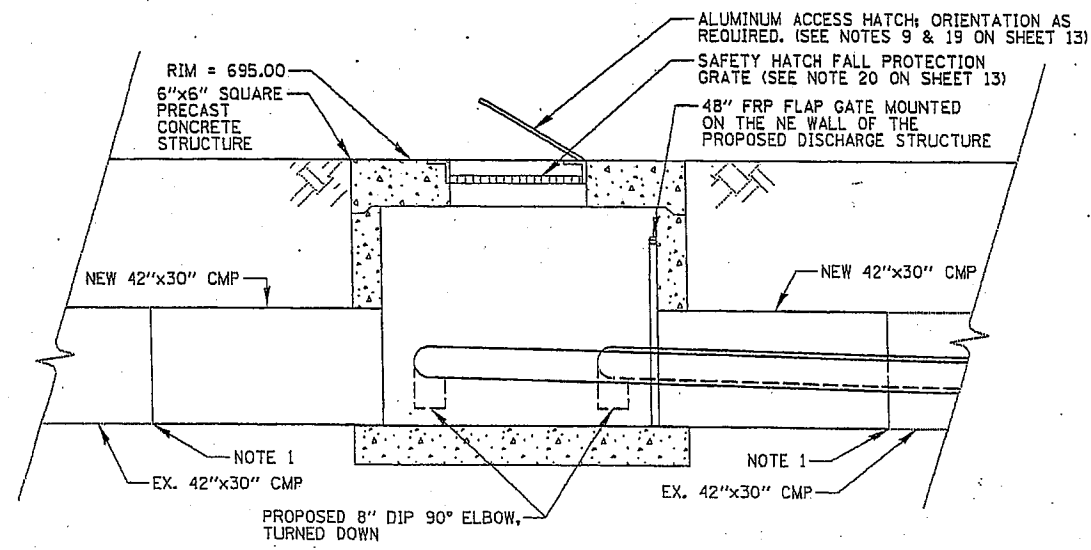

**PROPOSED DISCHARGE STRUCTURE DETAIL**

N.T.S.

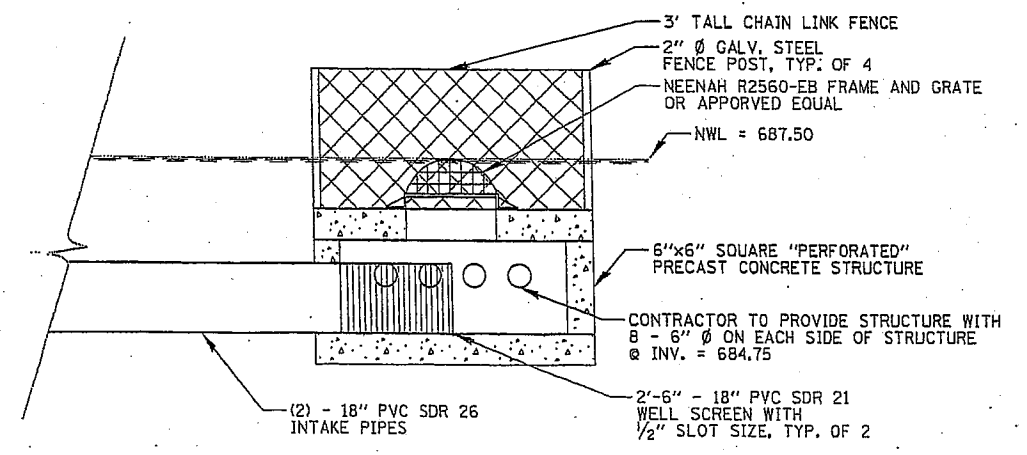

**PROPOSED INTAKE STRUCTURE DETAIL**

N.T.S.

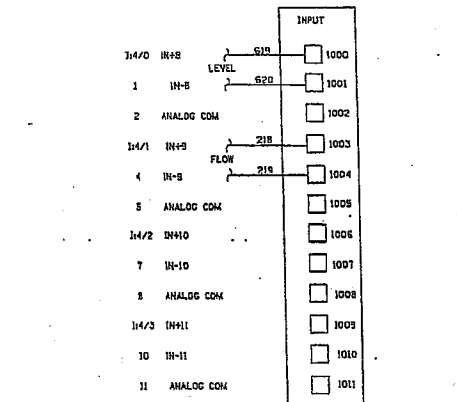
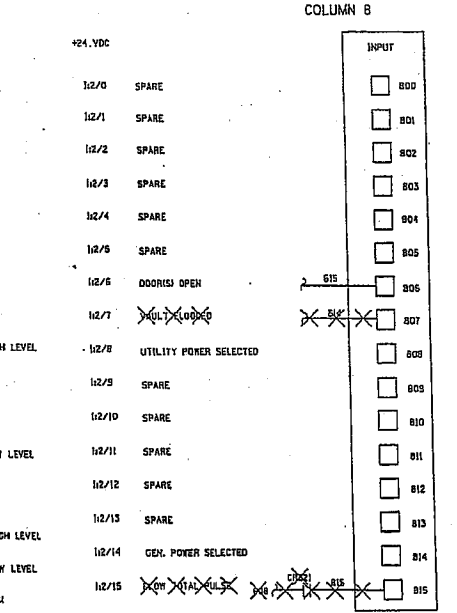
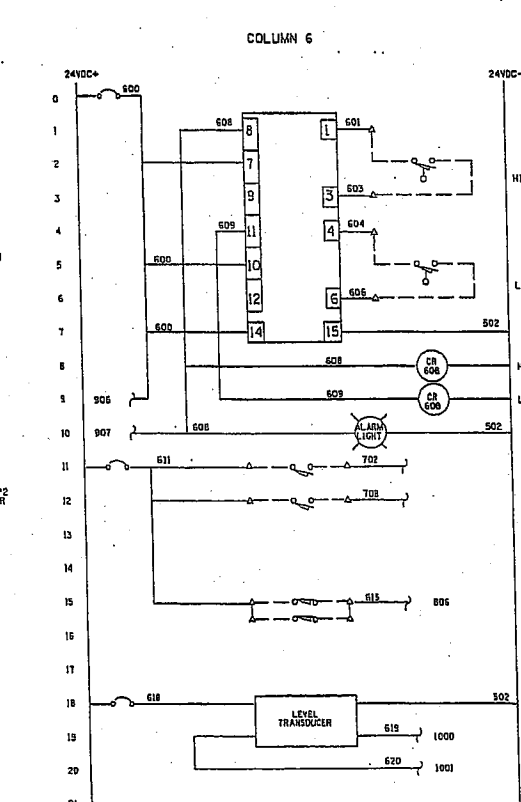
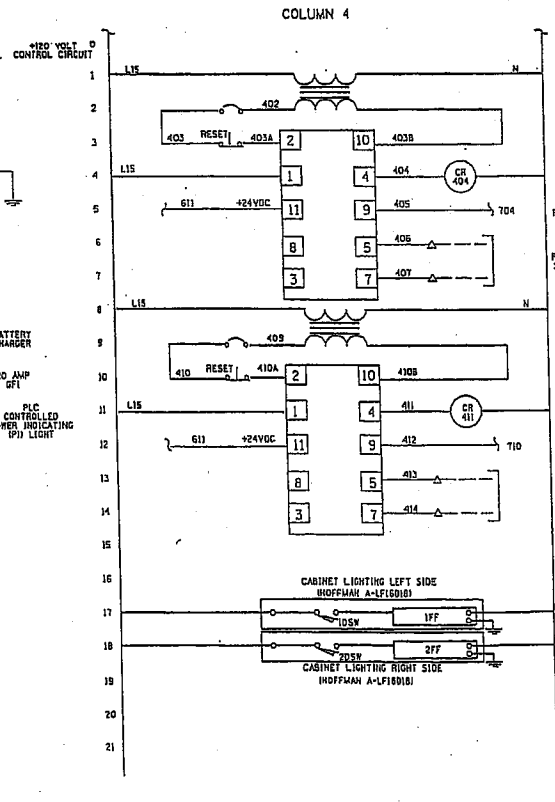
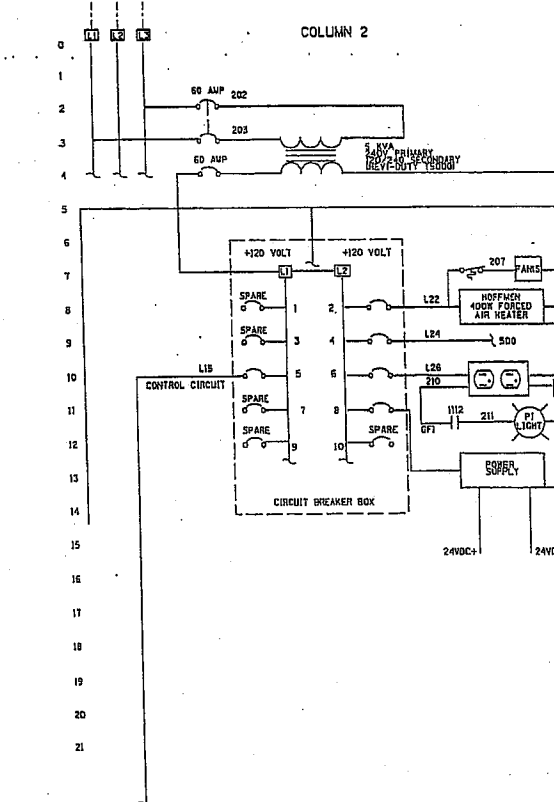
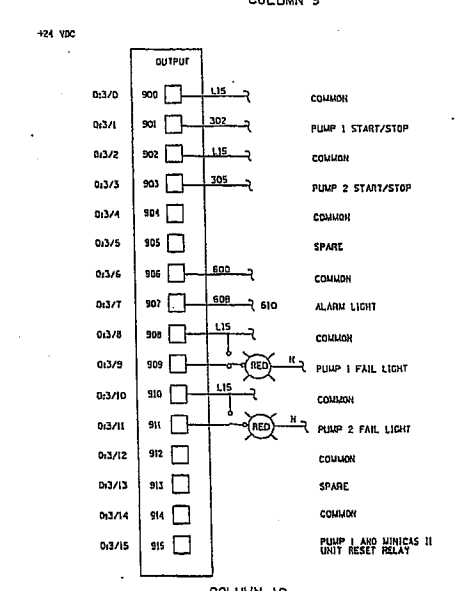
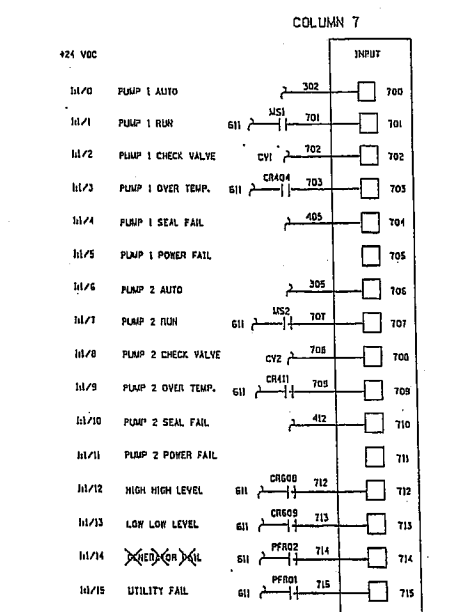
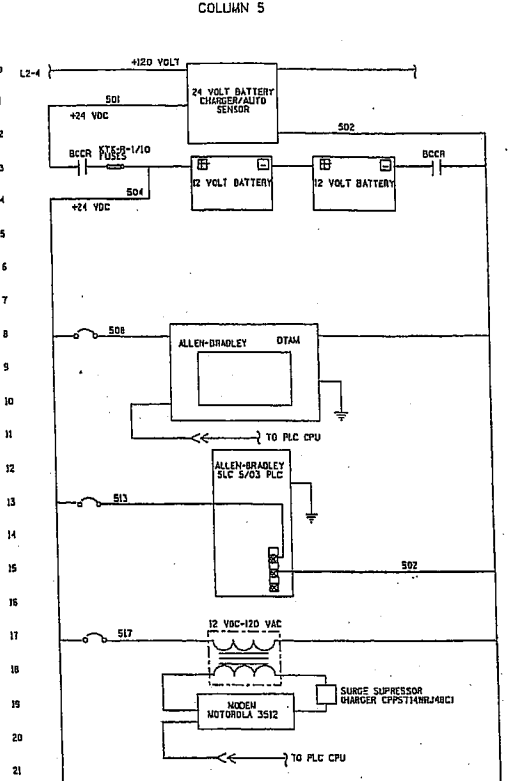
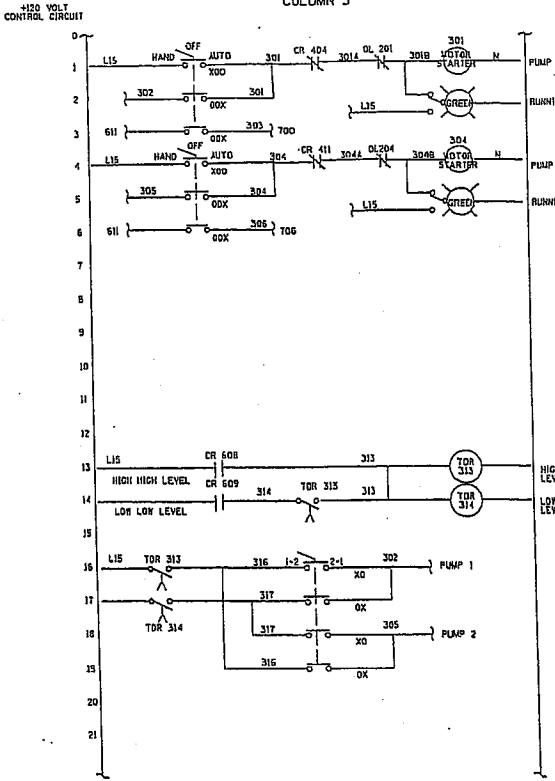
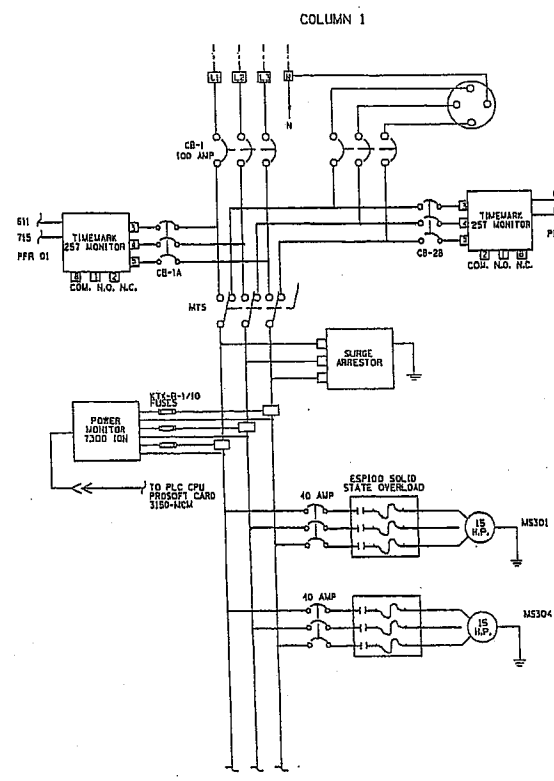

END SECTIONS FOR ROUND PIPE									
Dia.	Gauge	Weight	*A	*B	*H	*L	*W	Slope	Overall Width
8"	18	10	4	1	3	8	12	2	20"
8"	18	14	5 3/4	5	4	14 1/2	16	2 1/4	27 1/2"
10"	18	17	7 5/8	5	6	14 1/2	20	2 1/2	38 1/4"
12"	18	23	7	6	8	21	24	2 1/2	38"
15"	18	33	8	8	8	28	30	2 1/2	46"
18"	18	42	8	10	8	31	36	2 1/2	52"
21"	18	48	9	12	8	38	42	2 1/2	60"
24"	18	65	10	13	8	41	48	2 1/2	68"
30"	14	123	12	16	8	61	60	2 1/2	94"
36"	14	138	14	18	8	68	72	2 1/2	100"
42"	12	320	18	22	11	89	84	2 1/2	118"
48"	12	378	18	27	12	98	90	2 1/4	128"
54"	12	440	18	30	12	84	102	2 1/4	138"
60"	12/10	610	18	33	12	87	114	2	160"
66"	12/10	827	18	38	12	87	120	2	168"
72"	12/10	720	18	39	12	87	126	2	168"
78"	12/10	610	18	42	12	87	132	1 1/2	168"
84"	12/10	800	18	45	12	87	138	1 1/2	174"
90"	12/10	870	24	37	12	87	144	1 1/2	184"
96"	12/10	885	25	38	12	87	150	1 1/2	200"

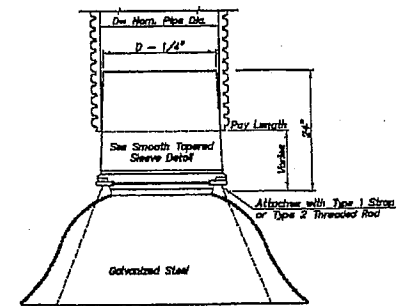

TAPERED SLEEVE FOR ATTACHING STEEL END SECTIONS TO SMOOTH PIPE

END SECTIONS FOR ARCHED PIPE										
Span & Rise Equivalent	Gauge	Weight	*A	*B	*H	*L	*W	Slope	Overall Width	
17x15	18"	16	23	7	9	6	19	32	2 1/2	44"
21x16	18"	18	32	7	10	6	23	38	2 1/2	50"
24x18	18"	18	42	8	12	6	28	42	2 1/2	58"
28x20	18"	18	52	9	14	6	32	48	2 1/2	66"
32x24	18"	14	62	10	16	6	36	60	2 1/2	80"
42x32	18"	14	113	12	18	9	49	78	2 1/2	98"
48x36	18"	18	233	13	21	12	53	85	2 1/2	111"
57x38	18"	18	316	18	24	12	63	90	2 1/2	126"
63x41	18"	18	330	18	25	12	63	90	2 1/2	126"
64x43	18"	18	367	18	30	12	70	108	2	138"
68x46	18"	18	375	18	34	12	70	102	2	138"
71x47	12/10	480	18	33	12	77	114	1 1/2	150"	
66x51	12/10	487	18	33	12	77	118	1 1/2	152"	
77x52	12/10	618	18	36	12	77	126	1 1/2	162"	
73x55	12/10	625	18	36	12	77	128	1 1/2	168"	
83x57	12/10	670	18	36	12	77	132	1 1/2	174"	
81x58	12/10	680	18	36	12	77	138	1 1/2	174"	
87x63	12/10	728	20	38	12	77	148	1 1/2	182"	
85x67	12/10	765	20	34	12	87	152	1 1/2	208"	
103x71	12/10	810	20	38	12	87	174	1 1/2	216"	
113x75	12/10	887	20	40	12	87	174	1 1/2	222"	

\* = Dimensions in inches Plus or Minus Standard Shop Tolerances.

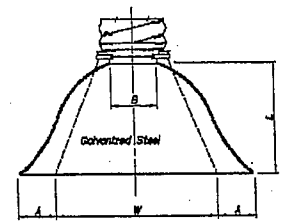

PLAN

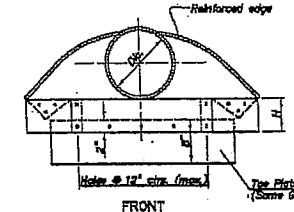

FRONT

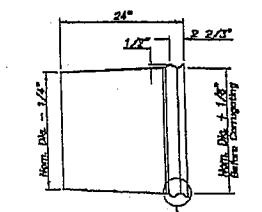

SMOOTH TAPERED SLEEVE DETAIL

NOTE: Metal to be 12 Gage Smooth Galvanized in accordance with AASHTO M218.

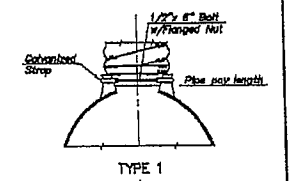

TYPE 1

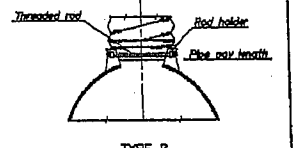

TYPE 2

No.	Date	Revisions
STANDARD END SECTION FOR ROUND & ARCHED PIPES		

**GENERAL NOTES**

The plate extensions where specified, to be punched to match holes in apron lip. 3/8" bolts to be furnished. The length of toe plate to be as follows:

- W + 10" for 12" to 30" diameter pipe inlets.
- W + 20" for 36" to 60" diameter pipe inlets.
- W + 10" for pipe arches with rise of 12" to 24" inclusive.
- W + 20" for pipe arches with rise of 33" to 72" inclusive.

Multiple panel end sections that have lap seams which are to be tightly lapped by bolts. Corner plate, and toe plate to be same gauge as end section.

For 60" and larger diameter pipe and sections, reinforced edges to be supplemented with hot dipped galvanized stiffener angles.

For 77" x 53" and larger pipe arch and sections, reinforced edges and outer panel seams to be supplemented by hot dipped galvanized stiffener angles.



**Exhibit "B"**

**LEGAL DESCRIPTION OF THE WEST CRYSTAL PARCEL**

**115 W. Crystal Street  
Lombard, Illinois 60148**

LOT 12 IN SALVATORI'S SUBDIVISION OF LOT "A" IN ELMORE'S NORTH VIEW, A SUBDIVISION IN THE NORTH HALF OF SECTION 6, TOWNSHIP 39 NORTH, RANGE 11, EAST OF THE THIRD PRINCIPAL MERIDIAN, ACCORDING TO THE PLAT OF SAID SALVATORI'S SUBDIVISION RECORDED MARCH 26, 1958 AS DOCUMENT 874722, IN DUPAGE COUNTY, ILLINOIS.