



To: Chairperson and Transportation and Safety Committee
From: Frank Kalisik, Civil Engineer II *FK*
Through: Carl S. Goldsmith, Director of Public Works *CSG*
Date: November 28, 2012
Subject: Yield Signs on Arboretum Drive

120624; Ordinance to Add Traffic Control Devices on Arboretum Drive

The intersections of Arboretum Drive with Lincoln and Edson Streets are currently uncontrolled. Due to these intersections' configurations, approaching vehicles to either of these intersections may find it difficult to determine which roadway is primary or secondary; thus, making it difficult to apply the governing right-of-way rule. Per the MUTCD, placement of a YIELD sign is warranted in these situations. Attached is a location map and copy of the Temporary Placement of Traffic Control Device regulation, which temporarily authorized the installation of these yield signs.

Staff supports permanently implementing the traffic control devices Arboretum Drive and recommends the Transportation and Safety Committee make a recommendation to the Village Board of Trustees with the following modification to the Traffic Code:

SCHEDULE V – PREFERENTIAL STREETS

In accordance with Section 10-9-5 and when signs are erected giving notice thereof, drivers of vehicles shall yield the right-of-way to the following streets at the intersections designated.

ADD: Arboretum Drive (westbound) will yield to Edson Street and Arboretum Drive.
ADD: Arboretum Drive (eastbound) will yield to Lincoln Street and Arboretum Drive.

cc: Zachary Wilson, District 3

Recommended YIELD Sign Placements

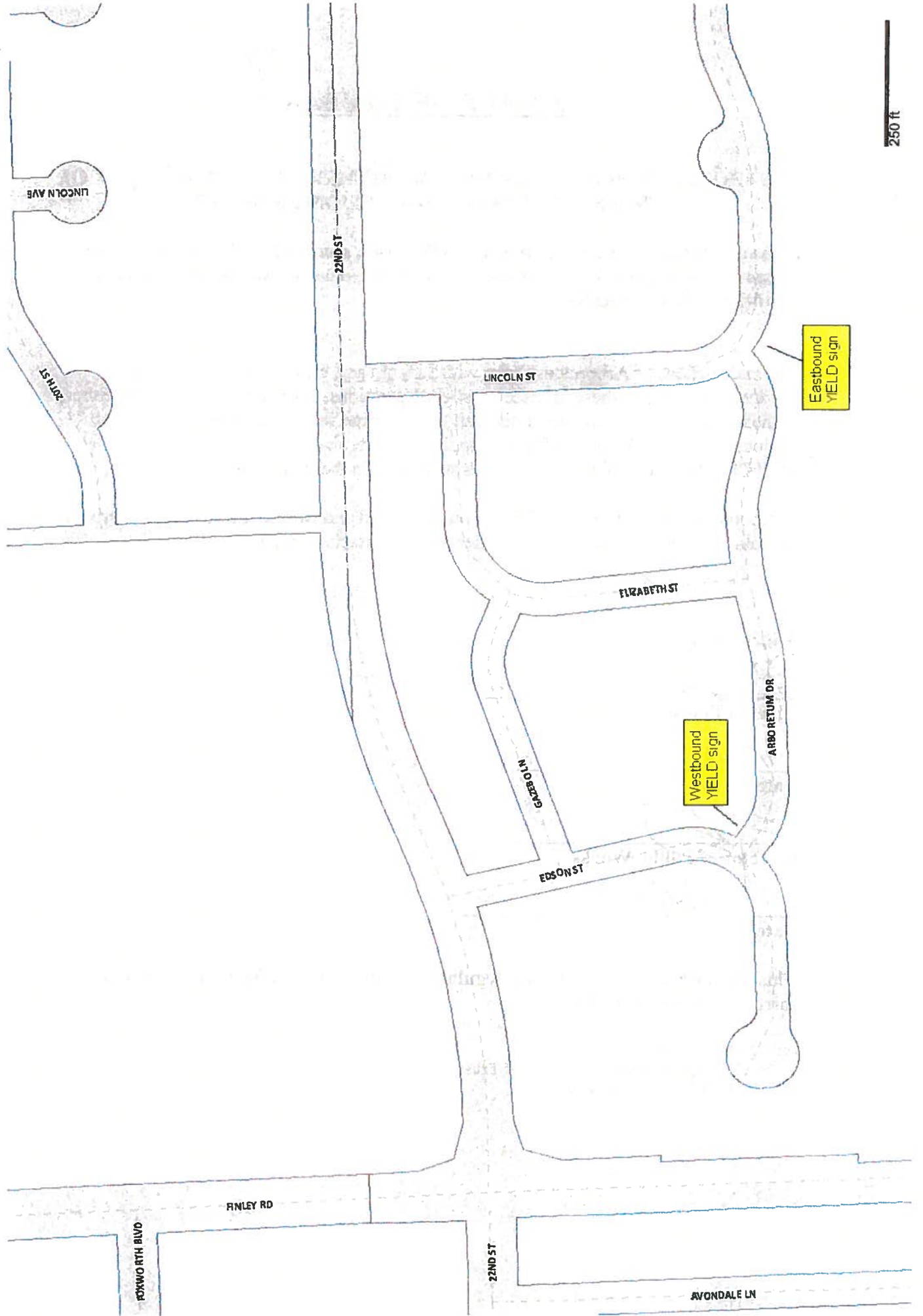

250 ft