

VILLAGE OF LOMBARD  
REQUEST FOR BOARD OF TRUSTEES ACTION  
For Inclusion on Board Agenda

\_\_\_\_\_ Resolution or Ordinance (Blue) \_\_\_\_\_ *Waiver of First Requested*  
\_\_\_\_\_ Recommendations of Boards, Commissions & Committees (Green)  
  X   Other Business (Pink)

TO: PRESIDENT AND BOARD OF TRUSTEES

FROM: William T. Lichter, Village Manager

DATE: April 28, 2004 (B of T) Date: May 6, 2004

TITLE: 1 W. St. Charles Road (Proposed Tribute Park)

SUBMITTED BY: Department of Community Development *Datt*

BACKGROUND/POLICY IMPLICATIONS:

The Department of Community Development submits for your consideration authorization for staff to waive the public bid requirements and solicit quotes for each component of the above project, not to exceed a total project cost of \$68,000. (DISTRICT #1)

Please place this item on the May 6, 2004 Board of Trustees agenda.

Fiscal Impact/Funding Source:

Review (as necessary):

Village Attorney X _____	Date _____
Finance Director X _____	Date _____
Village Manager X <i>William T. Lichter</i>	Date <u>4/29/04</u>

NOTE: All materials must be submitted to and approved by the Village Manager's Office by 12:00 noon, Wednesday, prior to the Agenda Distribution.

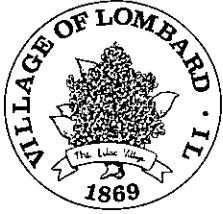

## MEMORANDUM

**TO:** William T. Lichter, Village Manager

**FROM:** David A. Hulseberg, AICP, *DAH*  
Director of Community Development

**DATE:** April 28, 2004

**SUBJECT:** 1 W. St. Charles Road – Proposed Tribute Park

Please present the attached item to the Board of Trustees for their review and consideration at the Board Meeting scheduled for May 6, 2004. Staff is requesting that the Board of Trustees waives the public bid requirements and authorize staff to solicit three quotes for each component of the project, up to a combined total of \$68,000.00 for all the items to complete the project.

Due to the scope of this project, involving underground storm sewer work, electrical work, irrigation work, concrete work, paver bricks, flagpoles, seat walls, etc... there are many items that would require a general landscaping contractor to hire sub contractors. As such staff feels that we could obtain better prices if the Village of Lombard acted as the general and hired out each component. To go through the public bid process for each of these components of the project could be lengthy. Staff feels that the construction of the project could be expedited if we only had to obtain three quotes for each component.

Attached you will find a drawing of the proposed tribute park. Please note that the seat wall planter has been revised to be square in shape. Constructing a round seat wall planter would require and a lot of custom stone work to create a curved capstone thus dramatically increases the cost. Hence, the shape of the seat wall planter has been revised. Also attached are two costs estimates one with the seat wall planter and one without. Currently \$50,000.00 has been budgeted for the project.

cc: PES File

m:\worduser\pes\matt\seven-eleven\7-11ProjectScope&Estimatebot-memo.doc

Proposed Tribute Park  
 By: Village of Lombard



04-24-04  
 Drawn By: MJF

Exhibit "A"

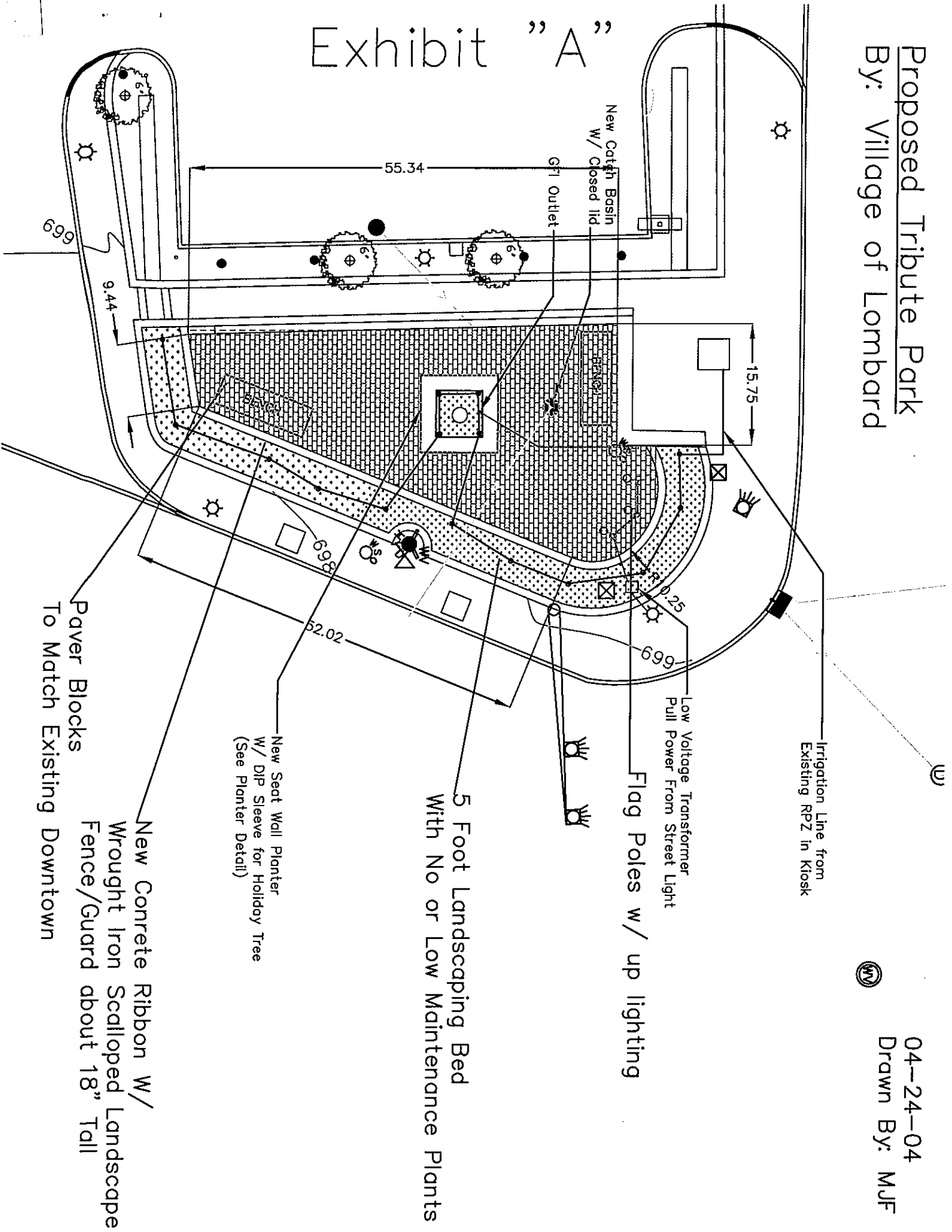

Irrigation Line from Existing RPZ in Kiosk

Low Voltage Transformer Pull Power from Street Light

Flag Poles w/ up lighting

5 Foot Landscaping Bed With No or Low Maintenance Plants

New Seat Wall Planter w/ DIP Sleeve for Holiday Tree (See Planter Detail)

New Concrete Ribbon w/ Wrought Iron Scalloped Landscape Fence/Guard about 18" Tall  
 Paver Blocks To Match Existing Downtown

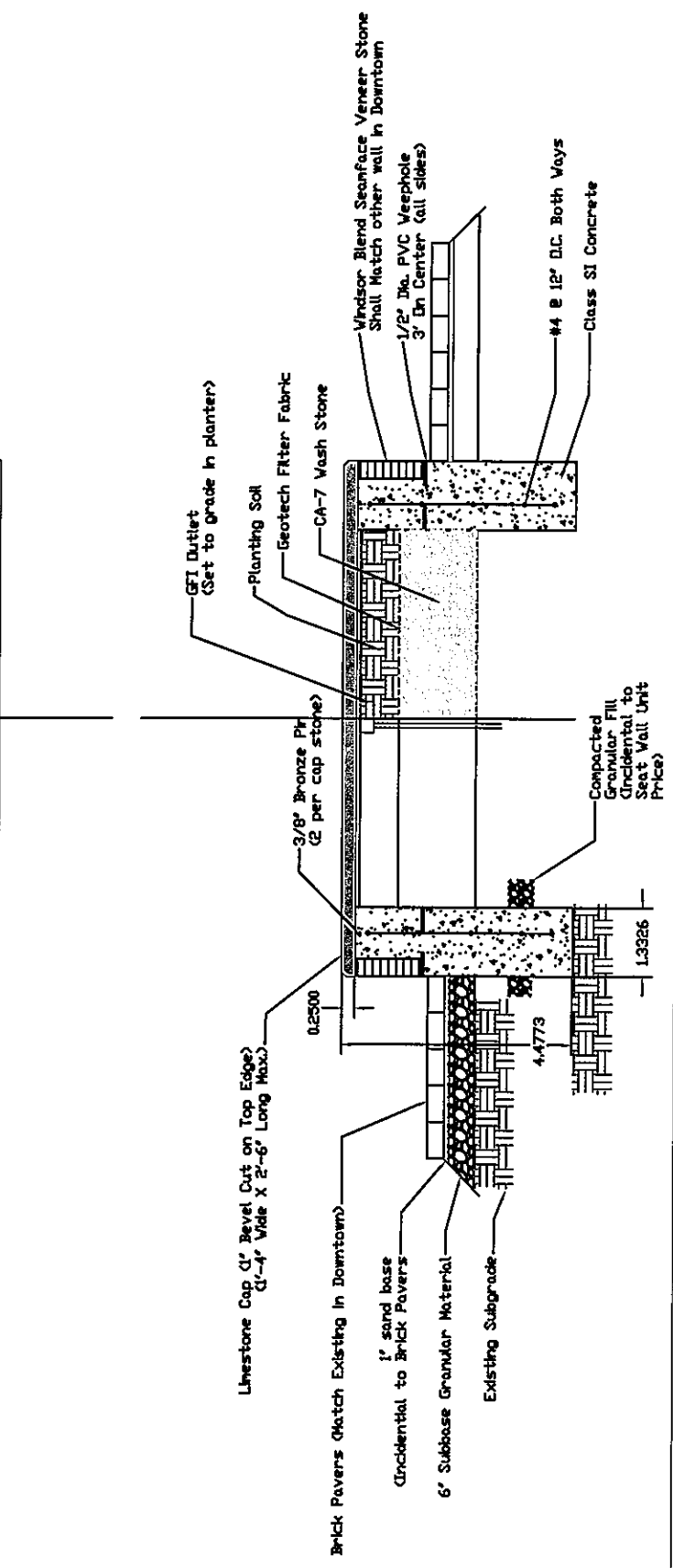
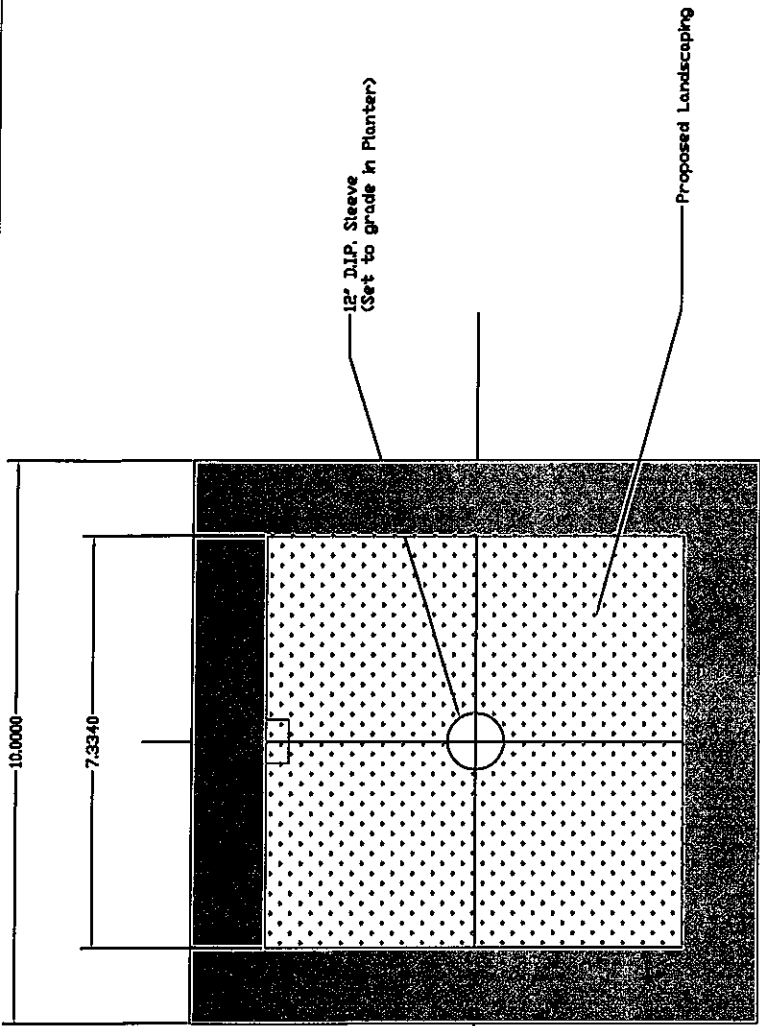

12" D.I.P. Sleeve  
(Set to grade in Planter)

Proposed Landscaping

GFI Outlet  
(Set to Grade in planter)

Limestone Cap (1" Bevel Cut on Top Edge)  
(1'-4" Wide X 2'-6" Long Mod.)

Brick Pavers (Match Existing in Downtown)

1" sand base  
(Incidental to Brick Pavers)

6" Subbase Granular Material

Existing Subgrade

3/8" Bronze Plr  
(2 per cap stone)

Planting Soil

Geotech Filter Fabric

CA-7 Wash Stone

Windsor Blend Seaface Veneer Stone  
Shall Match other wall in Downtown

1/2" Dia. PVC Weephole  
3' On Center (all sides)

#4 @ 12" O.C. Both Ways  
Class SI Concrete

Compacted  
Granular Fill  
(Incidental to  
Seat Wall Unit  
Price)

1.3326

4.4773

0.2500

**ESTIMATE WITHOUT SEAT WALL PLANTER**

ITEM	UNIT	QTY	UNIT/PRICE	TOTAL
Concrete Ribbon Remove & Replace	LS	1	\$ 3,675.00	\$ 3,675.00
Remove Catch Basin & Restrictor	EA	1	\$ 1,500.00	\$ 1,500.00
Manhole TYP A 4' DIA	EA	1	\$ 3,000.00	\$ 3,000.00
Flag Poles (Set of 3 - (20',25',20'))	LS	1	\$ 2,450.00	\$ 2,450.00
Flag Pole Foundations	EA	3	\$ 500.00	\$ 1,500.00
Concrete Pavers	SF	1235	\$ 12.00	\$ 14,820.00
Gravel Fill (CA-6)	CY	100	\$ 30.00	\$ 3,000.00
In-ground Up Lighting Fixtures	EA	3	\$ 300.00	\$ 900.00
Low Voltage Transformer	EA	1	\$ 300.00	\$ 300.00
Conduit & Wiring for Lights	LS	1	\$ 1,000.00	\$ 1,000.00
Landscaping	LS	1	\$ 5,000.00	\$ 5,000.00
18" tall scalloped iron fence	LS	1	\$ 1,000.00	\$ 1,000.00
Irrigation	LS	1	\$ 7,500.00	\$ 7,500.00
Tribute Plaque and Mounting Stone	LS	1	\$ 500.00	\$ 500.00

**ESTIMATE WITH SEAT WALL PLANTER**

ITEM	UNIT	QTY	UNIT/PRICE	TOTAL
Concrete Ribbon Remove & Replace	LS	1	\$ 3,675.00	\$ 3,675.00
Remove Catch Basin & Restrictor	EA	1	\$ 1,500.00	\$ 1,500.00
Manhole TYP A 4' DIA	EA	1	\$ 3,000.00	\$ 3,000.00
Flag Poles (Set of 3 - (20',25',20'))	LS	1	\$ 2,450.00	\$ 2,450.00
Flag Pole Foundations	EA	3	\$ 500.00	\$ 1,500.00
Concrete Pavers	SF	1075	\$ 12.00	\$ 12,900.00
Gravel Fill (CA-6)	CY	100	\$ 30.00	\$ 3,000.00
In-ground Up Lighting Fixtures	EA	3	\$ 300.00	\$ 900.00
Low Voltage Transformer	EA	1	\$ 300.00	\$ 300.00
Conduit & Wiring for Lights	LS	1	\$ 1,000.00	\$ 1,000.00
Landscaping	LS	1	\$ 5,000.00	\$ 5,000.00
18" tall scalloped iron fence	LS	1	\$ 1,000.00	\$ 1,000.00
Irrigation	LS	1	\$ 9,000.00	\$ 9,000.00
Tribute Plaque and Mounting Stone	LS	1	\$ 500.00	\$ 500.00
Seat Wall Planter w/ face stone & elect.	LS	1	\$ 20,000.00	\$ 20,000.00
				\$ 65,725.00

Note: Highlighted items indicate estimates are still being developed for these items.

## ***Proposed Tribute Park 1 W. St. Charles Road***

---

**Tribute park at the SW corner of St. Charles Road and  
Main Street (east of 7-Eleven parking lot)**

Village Board meeting  
May 5, 2004

## ***Project Summary***

---

- 7-Eleven will dedicate land as public right-of-way
- Village to act as general contractor
- Obtain 3 quotes for each subcontractor
  - Storm sewer, irrigation, concrete, etc.
- Total project cost: up to \$68,000

## ***Images of Site***

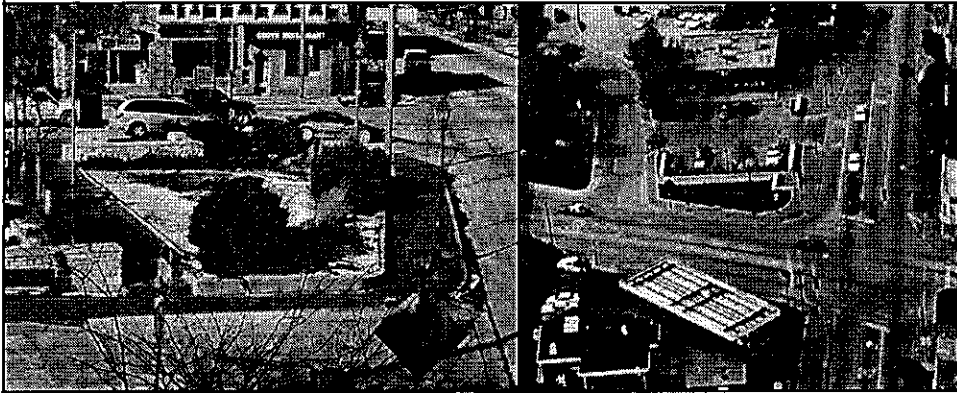

3

## ***Action Requested***

- Staff requests waiver of public bid requirements
- Staff requests authorization to solicit 3 quotes for each project component

4