

030212

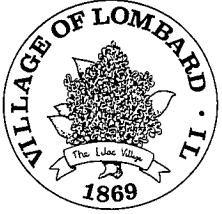

To: Stan Rickard, Director of Public Works  
From: John Johnson, Technical Services Supervisor *JJ*  
Date: March 6, 2003  
Subject: Parking Problems Around Sacred Heart Church

I recently received a complaint regarding vehicles parking close to the intersections in the vicinity of Sacred Heart Church, causing sight obstructions. While investigating, I witnessed vehicles parking up to the intersections, and in a few instances, over the crosswalks.

There are established school crossings at Maple and Brewster and at Maple and Elizabeth. Moving the vehicles away from the intersections will provide better sight distance for the pedestrians crossing.

When vehicles park on both sides and/or up to the intersection on Brewster, the vehicles turning off of Maple on to Brewster have to backup on to Maple or pull into someone's driveway to allow oncoming traffic to pass. Moving vehicles away from the intersection will provide an improved buffer zone.

I am recommending the following "No Parking" sign installations (see attached map).

cc: Rick Stoderstrom, Trustee, District 6  
Joan DeStephano, Trustee, District 1  
Reverend Joseph Tapella, 322 W. Maple St.  
Transportation and Safety Committee

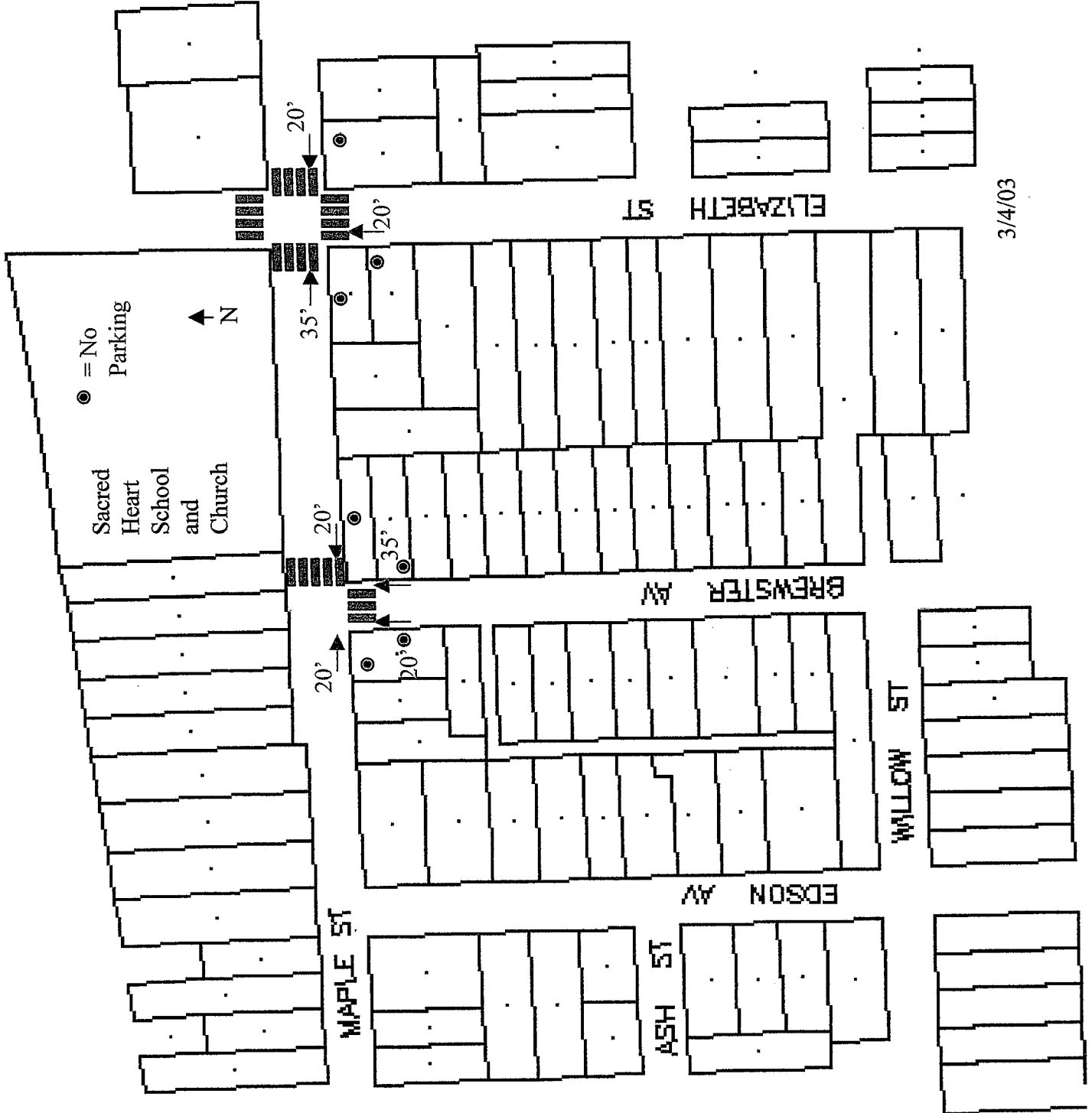

3/4/03