

VILLAGE OF LOMBARD  
REQUEST FOR BOARD OF TRUSTEES ACTION  
For Inclusion on Board Agenda

Resolution or Ordinance (Blue) \_\_\_\_\_  
Waiver of First Requested  
Recommendations of Boards, Commissions & Committees (Green) \_\_\_\_\_  
Other Business (Pink) \_\_\_\_\_

TO: PRESIDENT AND BOARD OF TRUSTEES

FROM: William T. Lichter, Village Manager

DATE: July 25, 2007 BOT Date: August 9, 2007

TITLE: Resolution Accepting the Public Improvements for 130 S. Main Street (Elmhurst Memorial Health Center)

SUBMITTED BY: Department of Community Development *del*

BACKGROUND/POLICY IMPLICATIONS:

The Department of Community Development transmits for your consideration a proposed resolution to accept the public sidewalk, storm sewer, sanitary sewer, water main and on-site 6-inch and 8-inch water main and fire hydrant installed as part of Elmhurst Memorial Health Center at 130 S. Main Street. All public improvements were designed, constructed and tested in conformance with Village requirements. (DISTRICT #1)

Staff recommends approval of this resolution.

FISCAL IMPACT/FUNDING SOURCE:

The public improvements were constructed by the project owner at no cost to the Village.

REVIEW (AS NECESSARY):

Village Attorney X \_\_\_\_\_ Date \_\_\_\_\_  
Finance Director X \_\_\_\_\_ Date \_\_\_\_\_  
Village Manager X *[Signature]* \_\_\_\_\_ Date 7-27-07



**MEMORANDUM**

**TO:** William T. Lichter, Village Manager

**FROM:** Nick Hatfield, PE, Development Engineer *Nick Hatfield*

**DATE:** July 25, 2007

**SUBJECT:** ACCEPTANCE OF PUBLIC SIDEWALK, STORM SEWER,  
SANITARY SEWER, WATER MAIN AND HYDRANTS AT 130 S.  
MAIN STREET (ELMHURST MEMORIAL HEALTH CENTER), IN  
LOMBARD, ILLINOIS

The Private Engineering Services Division of the Community Development Department recommends that the Board of Trustees accept the public sidewalk, storm sewer, sanitary sewer, water main and on-site 6-inch and 8-inch water main and fire hydrants at 130 S. Main Street (Elmhurst Memorial Health Center). Attached is the updated utility map. Please present the attached resolution to the Board of Trustees at their August 9, 2007 meeting.

The stated improvements are acceptable since they were installed substantially to plan and have passed all required tests. The Private Engineering Services Division has approved the project record drawings. The on-site sanitary sewer, fire suppression and water service mains, and the storm sewer will remain the responsibility of the property owner.

Please note that this project was completed two years ago, at which time the Department collected a letter of credit for the required two-year maintenance period. Required easements over the water mains and fire hydrants were not provided to the Village and thus the improvements were not accepted. This issue was resolved with the building permit submittal for the proposed MRI addition to the health center. The Plat of Easements is on this Board Meeting's agenda and thus the project is ready for acceptance.

NH:nh

H:\CD\WOR\RD\USER\ESS\Nick\Memos\Public Improvement Acceptance\Elmhurst Memorial Health Center\Memo - PES to VM.doc

cc: David A. Hulseberg, AICP, Asst. Village Mgr. and Director of Community Development  
Wesley B. Anderson, PE, Director of Public Works  
Angela Podesta, Utilities Superintendent

R E S O L U T I O N  
R \_\_\_\_\_  
08

**RESOLUTION ACCEPTING PUBLIC SIDEWALK, STORM SEWER,  
SANITARY SEWER, WATER MAIN AND HYDRANTS AT 130 S. MAIN  
STREET (ELMHURST MEMORIAL HEALTH CENTER), IN LOMBARD,  
ILLINOIS**

WHEREAS, the Private Engineering Services Division of the Village of Lombard has certified the completion of the public sidewalk, storm sewer, sanitary sewer, water main and on-site 6-inch and 8-inch water main and hydrants at 130 S. Main Street (Elmhurst Memorial Health Center), and has recommended that said improvements be accepted; and WHEREAS, the Corporate Authorities concur with said recommendation.

NOW, THEREFORE, BE IT RESOLVED BY THE PRESIDENT AND BOARD OF TRUSTEES OF THE VILLAGE OF LOMBARD, DU PAGE COUNTY, ILLINOIS, AS FOLLOWS:

SECTION 1: That the public improvements, as certified by the Private Engineering Services Division and as set forth on the approved engineering plans for the public sidewalk, storm sewer, sanitary sewer, water main and on-site 6-inch and 8-inch water main and hydrants at 130 S. Main Street (Elmhurst Memorial Health Center), be and hereby are accepted for ownership by the Village of Lombard.

SECTION 2: That the on-site sanitary sewer, water service and fire suppression mains, and storm sewer are to remain the responsibility of the property owner.

Adopted this \_\_\_\_\_ day of \_\_\_\_\_, 2007.

Ayes: \_\_\_\_\_

Nays: \_\_\_\_\_

Absent: \_\_\_\_\_

Approved this \_\_\_\_\_ day of \_\_\_\_\_, 2007.

ATTEST:  
William J. Mueller, Village President

Brigitte O'Brien, Village Clerk

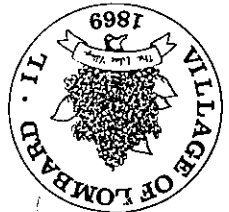

**CERTIFICATE OF COMPLETION OF PUBLIC SIDEWALK, STORM SEWER,  
SANITARY SEWER, WATER MAIN AND HYDRANTS AT 130 S. MAIN  
STREET (ELMHURST MEMORIAL HEALTH CENTER), IN LOMBARD,  
ILLINOIS**

We, as representatives of the Village of Lombard, certify that the public sidewalk, storm sewer, sanitary sewer, water main and on-site 8-inch water main and hydrants at 130 S. Main Street (Elmhurst Memorial Health Center), have been constructed substantially per plan and have passed all required tests.

We recommend acceptance by the Village President and the Board of Trustees of the Village of Lombard.

Recommended for acceptance:

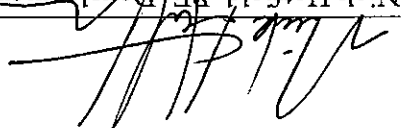
  
Nick Hatfield, PE, Development Engineer  
Private Engineering Services Division

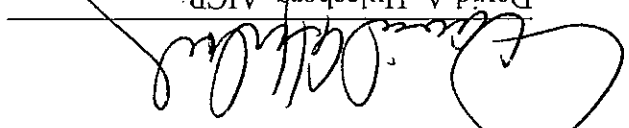
  
David A. Huliseberg, AICP,  
Assistant Village Manager  
Director Department of Community Development

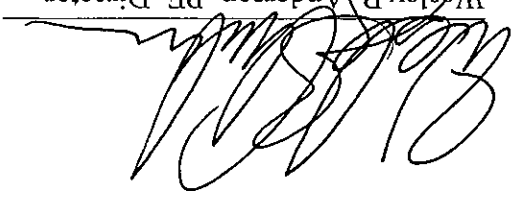
  
Wesley B. Anderson, PE, Director  
Department of Public Works

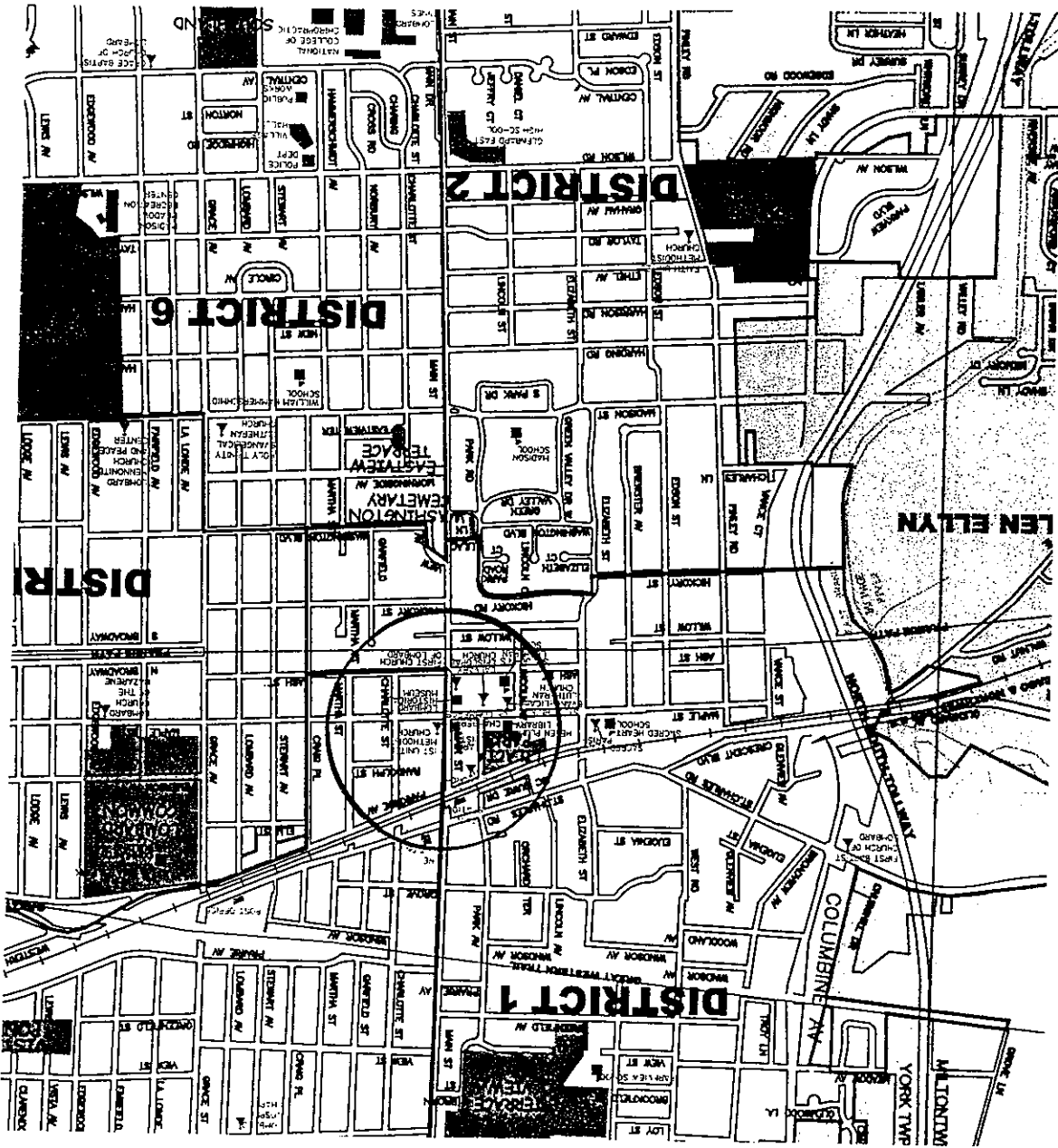

ELMHURST MEMORIAL HEALTH CENTER

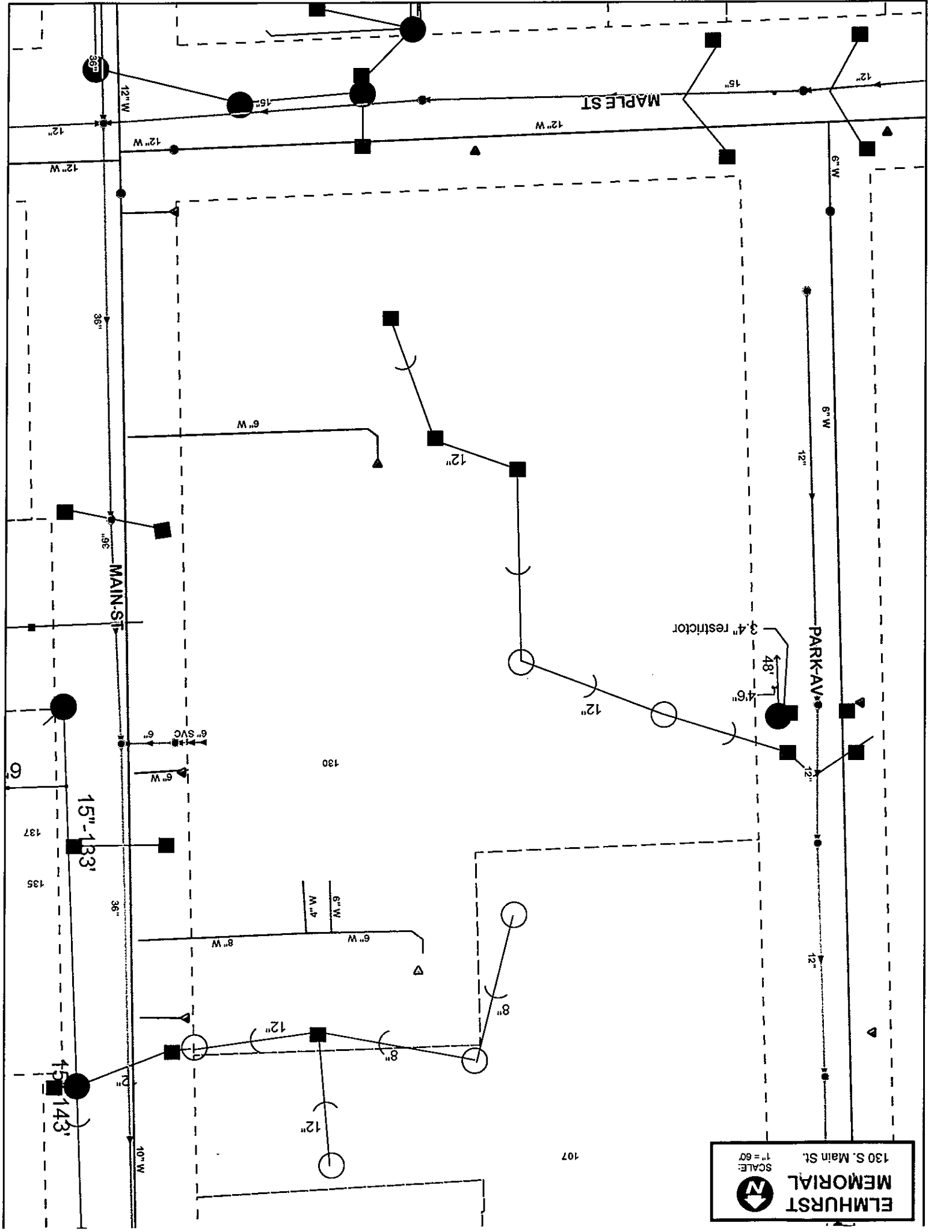

ELMHURST  
 MEMORIAL  
 130 S. Main St.  
 SCALE: 1" = 60'  

107

130

6" W  
M.A.P

15" - 133'

15" - 143'

MAIN ST

MAPLE ST

PARK AV

3.4" restrictor  
48"  
46"

12" W

12" W

12" W

36"

36"

6" SVC  
6"

6" W

6" W  
8" W

12"

12"

12"

10" W

12"

12"

12"

12"

12"

12"

12"

12"

12"

12"

12"

12"

12"

12"

12"

12"

12"

12"

12"

12"

12"

12"

12"

12"

12"

12"

12"

12"

12"

12"

12"

12"

12"

12"

12"

12"

12"

12"

12"

12"

12"

12"

12"

12"

12"

12"

12"

12"

12"

12"

12"

12"

12"

12"

12"