

FRED BUCHOLZ
 DUPAGE COUNTY RECORDER
 AUG. 16, 2007 9:30 AM
 OTHER 06-21-111-003
 004 PAGES R2007-152827

AFFIDAVIT

Now comes Janet Downer, an employee of the Village of Lombard after being duly sworn and under oath states as follows:

That on August 14, 2007 I deposited into the U.S. Mail in the Village of Lombard the attached "Notice of Annexation" which was sent out via Certified Mail to the person listed on the Notice.

THE VILLAGE OF LOMBARD

By: *Janet L. Downer*

SUBSCRIBED and SWORN
 to before me this 14th day
 of August, 2007.

William J Heniff
 NOTARY PUBLIC

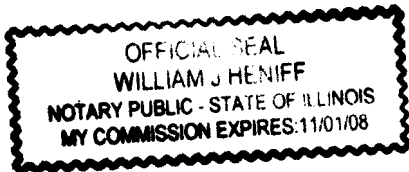

Return To:

Village of Lombard
 Dept. of Community Development
 255 E. Wilson Avenue
 Lombard, IL 60148

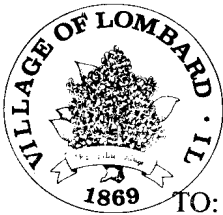

NOTICE OF ANNEXATION OF PROPERTY INTO
THE VILLAGE OF LOMBARD

TO: YORK CENTER FIRE PROTECTION DISTRICT

William Cizek, Trustee
1S244 Holyoke Lane
Villa Park, IL 60181

Ronald Roth, Trustee
1416 S. Luther
Lombard, IL 60148

Frank Vosicky, Trustee
1701 S. School Street
Lombard, IL 60148

Shawn Flaherty
Ottosen, Trevarthenn, Britz, Kelly, Cooper Ltd.
300 S. County Farm Road
Wheaton, IL 60187

Re: **PC 07-28: 1420 S. Meyers Road, Lombard, IL**

Fellowship Reformed Church is requesting that the Village execute an Annexation Agreement and take the following actions associated with the agreement:

1. Annex the property to the Village of Lombard immediately following contiguity between the Village corporate limits and the subject property; and
2. Grant a conditional use for an existing religious institution located on the subject property.

You and each of you are hereby notified that the Village of Lombard, County of DuPage, will consider approval of an Annexation Agreement for the referenced property pursuant to the provisions of Chapter 65 ILCS 5/7-1-1 et. seq. of the Illinois State Statutes at the following time and place:

DATE: Thursday, September 6, 2007

TIME: 7:30 P.M.

LOCATION: Board Room
Lombard Village Hall
255 E. Wilson
Lombard, IL 60148

A legal description and a location map of the property are attached. If there are any questions or comments regarding this annexation, please contact the Village of Lombard, Department of Community Development.

Brigitte O'Brien
Village Clerk

Date: August 14, 2007

PC 07-28: 1420 S. Meyers Road, Lombard, IL 60149

PARCEL 1

THE WEST 117.0 FEET OF THE EAST 376.0 FEET OF THE NORTH 233.0 FEET OF THE SOUTH QUARTER OF THE NORTHWEST QUARTER OF SECTION 21, TOWNSHIP 39 NORTH, RANGE 11, EAST OF THE THIRD PRINCIPAL MERIDIAN IN DUPAGE COUNTY, ILLINOIS.

PARCEL 2

THE SOUTH 10.0 FEET OF LOT 1 IN HAVENGA'S PLAT OF SURVEY OF THE NORTH 233.0 FEET OF THE EAST 233.3 FEET OF THE SOUTHWEST QUARTER OF THE NORTHWEST QUARTER OF SECTION 21, TOWNSHIP 39 NORTH, RANGE 11, EAST OF THE THIRD PRINCIPAL MERIDIAN, ACCORDING TO THE PLAT RECORDED AS DOCUMENT 753858, IN DUPAGE COUNTY, ILLINOIS

PARCEL 3

LOT 1 OF MEYERS ROAD SUBDIVISION, BEING A SUBDIVISION OF THE NORTH 624.27 FEET OF THE EAST 376.0 FEET OF THE SOUTHWEST QUARTER OF THE NORTHWEST QUARTER OF SECTION 21, TOWNSHIP 39 NORTH, RANGE 11 EAST OF THE THIRD PRINCIPAL MERIDIAN, EXCEPT THE NORTH 233.3 FEET THEREOF, ACCORDING TO THE PLAT RECORDED SEPTEMBER 17, 1958 AS DOCUMENT 894969, ALL IN DUPAGE COUNTY, ILLINOIS.

Parcel Numbers: 06-21-111-003, -005, -006



NSIN AWISCONSIN AWISCONSIN AV

ADDISON AV ADDISON AV ADDISON AV

3RD ST 3RD ST 3RD ST 3RD ST

LUTHER AV LUTHER AV LUTHER AV LUTHER AV

CHURCH AV CHURCH AV CHURCH AV CHURCH AV

MEYERS RD MEYERS RD MEYERS RD MEYERS RD

SCHOOL ST SCHOOL ST

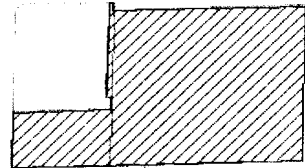

ROOSEVELT RD

13TH ST

14TH ST

ROCHDALE CIR

ROCHDALE CIR

16TH ST 16TH ST



1 in. = 400.0 feet

PC 07-28: 1420 S. Meyers Road

