

NEIGHBOR EXST. PEP BOYS

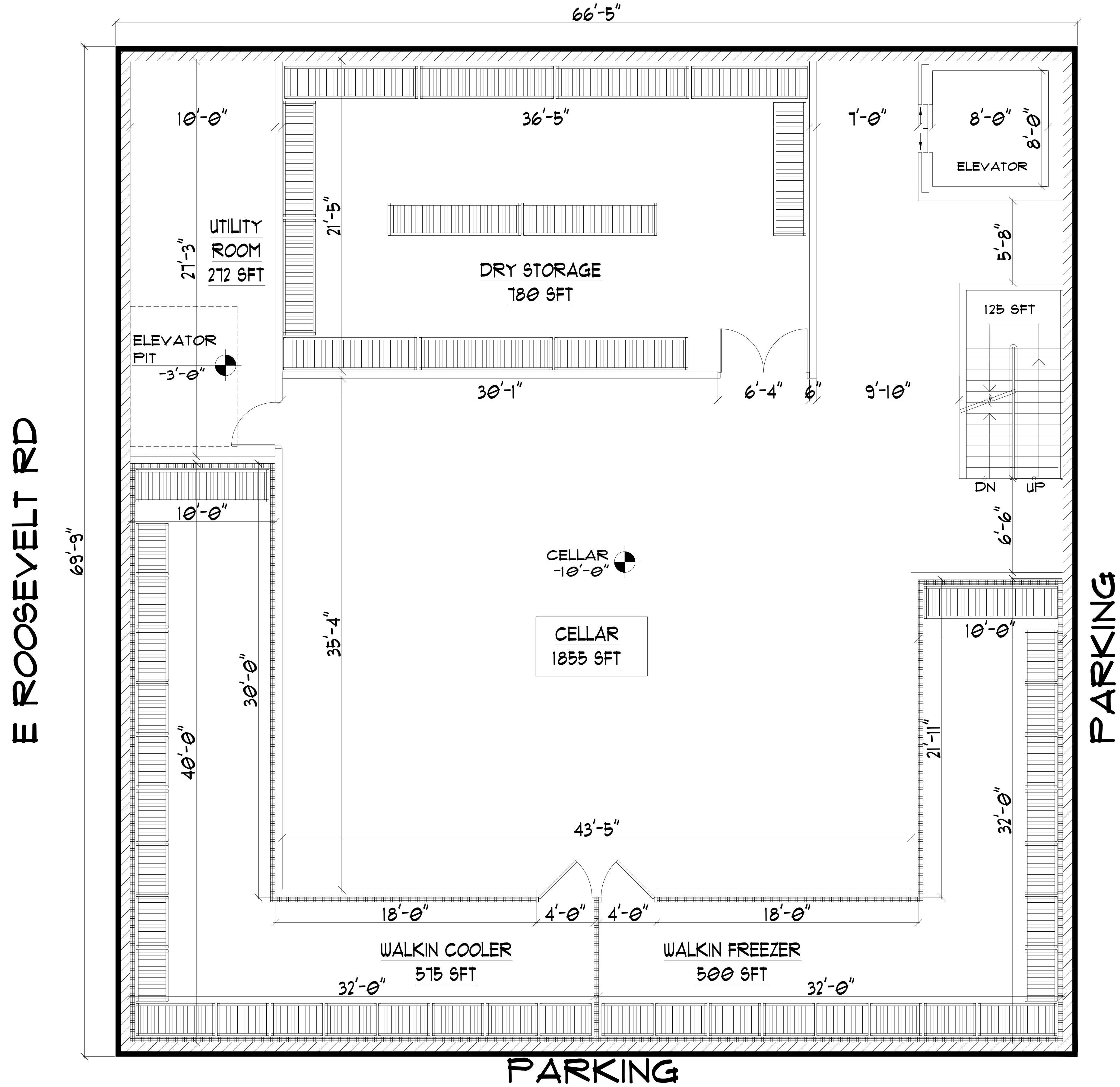

2 PROPOSED CELLAR PLAN  
SCALE: 1/4"=1'-0" NORTH

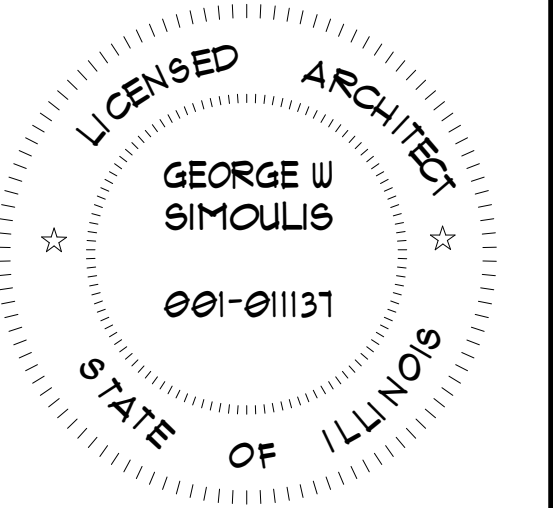

**ADC** ALL DESIGN & CONSTRUCTION, LLC  
 MAQB00L1300@YAHOO.COM  
 2104 WEST PETERSON AVENUE, CHICAGO, IL 60659  
 CELL: 773 291 1938

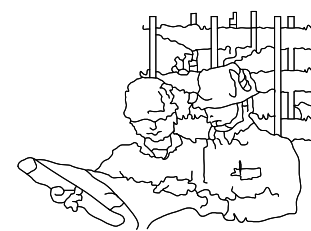

LOCATION:  
E ROOSEVELT RD,  
LOMBARD, IL

SHEET TITLE  
PROPOSED CELLAR PLAN

DRAWN BY:	DRAWINGS	DATE:
MNU	REVISIONS PER TEAM	01/20/2022

ARCHITECT  
GEORGE SIMOULIS

SCALE:  
1/4"=1'-0"  
DRG. NO. A-2